

FILE: 00307_A1_TITLE.dwg | DATE: | LAYOUT: A1 | DESIGNED: JAM | CHECKED: JAM | DRAFTED: WJP

STATE OF ALASKA

DEPARTMENT OF TRANSPORTATION & PUBLIC FACILITIES

PROPOSED HIGHWAY PROJECT

JUNEAU: EGAN-YANDUKIN INTERSECTION IMPROVEMENTS

PROJECT NO. 0003261/SFHWHY00307

PAVING, SIGNING, STRIPING, ILLUMINATION

NO.	DATE	REVISIONS	STATE	PROJECT DESIGNATION	YEAR	SHEET NO.	TOTAL SHEETS
			ALASKA	0003261/SFHWHY00307	2022	A1	22
				CDS ROUTE: 296000	MILEPOINT: 6.141 TO 8.746		
				LATITUDE: 58°30'7.2"N	LONGITUDE: 134°31'44.4"W		

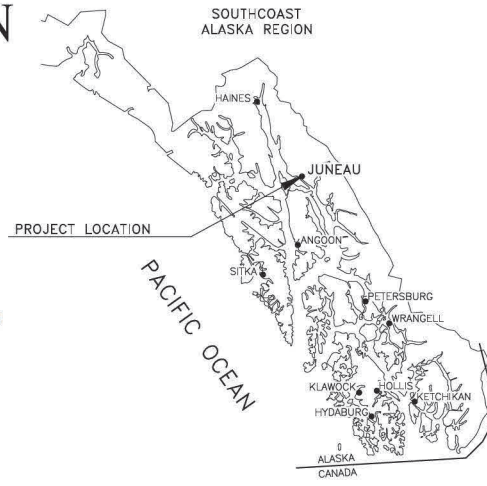

DESIGN DESIGNATIONS	
PROJECT TYPE	HSIP
ROAD	EGAN DRIVE
FUNCTIONAL CLASS	PRINCIPAL ARTERIAL
ADT (2021)	28,108
ADT (2022)	28,178
DHV	3,100
PERCENT TRUCKS (T)	3%
DIRECTIONAL SPLIT (D)	60 / 40
DESIGN SPEED (V)	55
DESIGN ESAL'S (20 YEARS)	N/A

PROJECT SUMMARY	
WIDTH OF PAVEMENT	N/A
LENGTH OF PAVING	N/A
LENGTH OF PROJECT	2.4 MILES

As-Builts:
Contractor: SECON
Project Engineer: Shannon M. Kelly
Project Manager: John Kajdan, P.E.
Start Date: October 9, 2023
End Date: August 23, 2024

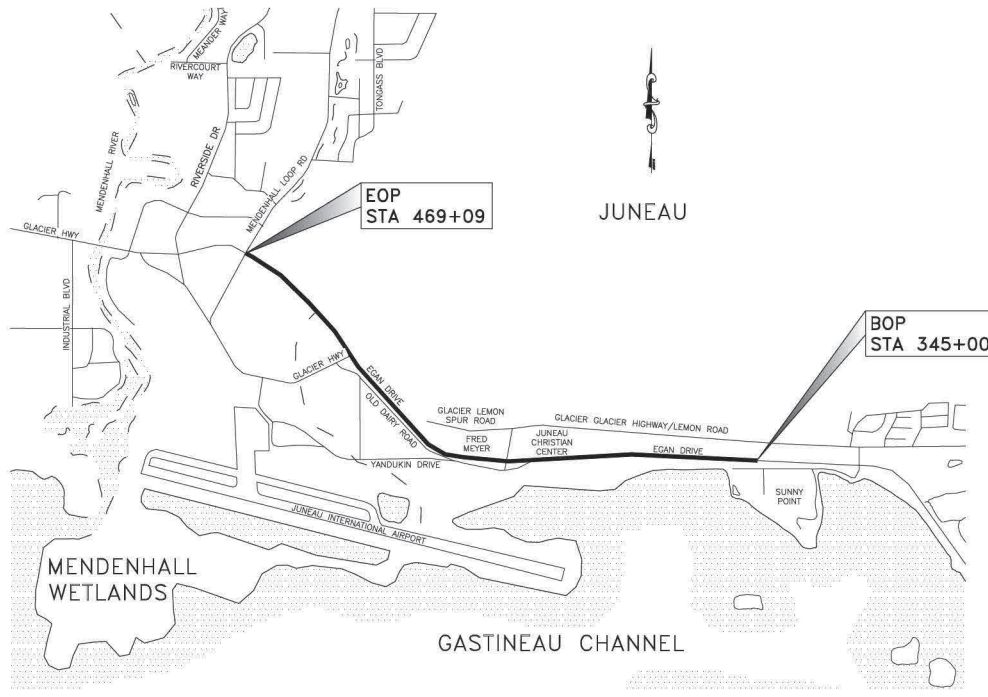

VICINITY MAP

USE THESE PLANS IN CONJUNCTION WITH THE STATE OF ALASKA STANDARD SPECIFICATIONS FOR HIGHWAY CONSTRUCTION, 2020 EDITION AND THE PROJECT SPECIAL PROVISIONS.

Record Drawings have been reviewed by the Project Engineer, and represent to the best of my knowledge, the project as constructed.
 PE *Shannon M. Kelly*

STATE OF ALASKA	
DEPARTMENT OF TRANSPORTATION & PUBLIC FACILITIES 6860 GLACIER HIGHWAY, JUNEAU, AK 99801 (907) 465-1763	
APPROVED:	
Designed by: <i>[Signature]</i>	1/5/2023
REGIONAL PRECONSTRUCTION ENGINEER KIRK MILLER, P.E.	DATE
CONCUR:	
Designed by: <i>[Signature]</i>	1/6/2023
REGIONAL DIRECTOR D. LANGE MEARIG, P.E.	DATE

PLANS DEVELOPED BY: KINNEY ENGINEERING, LLC, 3909 Arctic Blvd., Suite 400, Anchorage, Alaska 99503 (807) 346-2373 CERT. OF AUTH. NO. 1102
 FILE: 00307-A2-INDEX, ABBREVIATIONS & GENERAL NOTES.dwg DATE: 9/13/22 5:19 PM LAYOUT: A2 DESIGNED: JAM CHECKED: JWM DRAFTED: AF

NO.	DATE	REVISION	STATE	PROJECT DESIGNATION	YEAR	SHEET NO.	TOTAL SHEETS
			ALASKA	0003261/SFHWY00307	2022	A2	A7

INDEX OF SHEETS	
SHEET NO.	DESCRIPTION
A1	TITLE SHEET
A2	INDEX, ABBREVIATIONS & GENERAL NOTES
A3	LEGEND
A4	PROJECT OVERVIEW AND SHEET LAYOUT
A5-A7	SURVEY CONTROL
B1	TYPICAL SECTIONS
C1	ESTIMATE OF QUANTITIES
D1	SUMMARY TABLES
G1	GRADING PLAN
H1	PROPOSED SIGN LAYOUT
H2	SIGNING AND STRIPING PLAN
H3	SIGNING AND STRIPING DETAILS
H4	SIGN SUMMARY
H5-H8	ELECTRICAL PLANS
H9-H10	ELECTRICAL DETAILS
H11	LOAD CENTER SUMMARIES
T1	TRAFFIC CONTROL PLAN

Record Drawings have been reviewed by the Project Engineer, and represent to the best of my knowledge, the project as constructed.

PE *Shannon M. Kelly*

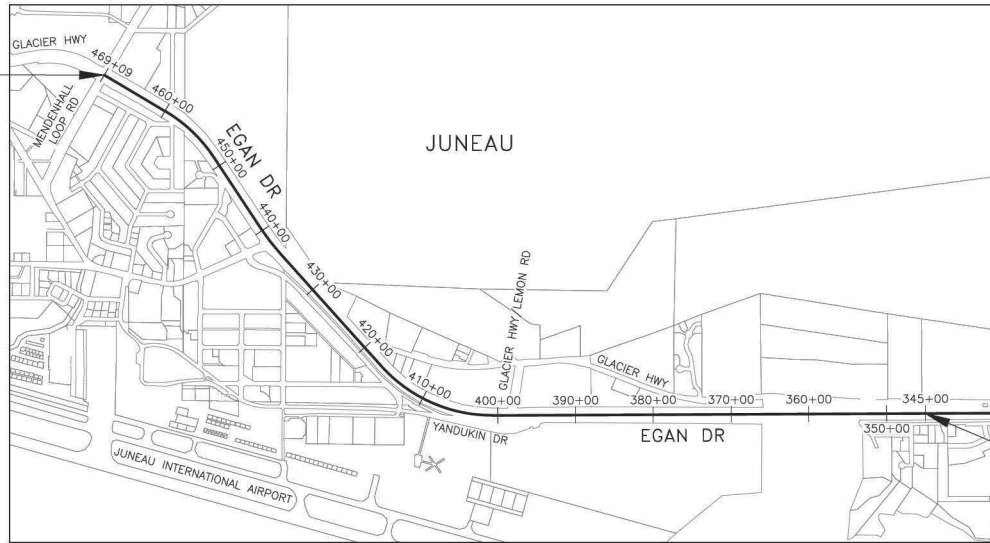

PROJECT ALIGNMENT

ABBREVIATIONS

ADA	AMERICANS WITH DISABILITIES ACT	EOTW	EDGE OF THE TRAVELED WAY	N/A	NOT APPLICABLE	SD	STORM DRAIN
ADT	AVERAGE DAILY TRAFFIC	ESCP	EROSION AND SEDIMENT CONTROL PLAN	NB	NORTHBOUND	SE	SOUTHEAST
ASDS	ALASKA SIGN DESIGN GUIDE	ESAL	EQUIVALENT SINGLE AXLE LOAD	NC	NATIONAL COARSE	SF	SQUARE FOOT
ASTM	AMERICAN SOCIETY FOR TESTING AND MATERIALS	EX	EXISTING	NE	NORTHEAST	SSHIC	STANDARD SPECIFICATIONS FOR HIGHWAY CONSTRUCTION
ATM	ALASKA TRAFFIC MANUAL	GA	GAUGE	NEMA	NATIONAL ELECTRIC MANUFACTURERS ASSOCIATION	SW	SOUTHWEST, SIDEWALK
BMP	BEST MANAGEMENT PRACTICE	H	HORIZONTAL	NFPA	NATIONAL FIRE PROTECTION ASSOCIATION	SWPPP	STORM WATER POLLUTION PREVENTION PLAN
BOP	BEGINNING OF PROJECT	HGT	HEIGHT	NO.	NUMBER	SY	SQUARE YARD
CBJ	CITY AND BOROUGH OF JUNEAU	HR	HOUR	NTS	NOT TO SCALE	TCP	TRAFFIC CONTROL PLAN
CF	CUBIC FOOT	HPS	HIGH PRESSURE SODIUM	NW	NORTHWEST	TYP.	TYPICAL
COP	CONSTRUCTION GENERAL PERMIT	GND	GROUND	O.C.	ON CENTER	USC&GS	U.S. COAST AND GEODETIC SURVEY
CKT	ELECTRICAL CIRCUIT	IES	ILLUMINATING ENGINEERING SOCIETY	PC	POINT OF CURVE	V	VERTICAL
CMB	CHANGEABLE MESSAGE BOARD	ILL	ILLUMINATION	PCC	PRECAST CONCRETE	WB	WESTBOUND
CS	CONTINGENT SUM	IN OR "	INCH	PI	POINT OF INTERSECTION	W/	WITH
DESC	DESCRIPTION	JBOX, J-BOX	JUNCTION BOX	PST	PERFORATED STEEL TUBE	W/O	WITHOUT
DH/V	DESIGN HOURLY VOLUME	LB	POUND	PT	POINT OF TANGENCY		
DIA	DIAMETER	LED	LIGHT EMITTING DIODE	QUAD	QUADRANT OR CORNER		
DIR	DIRECTION	LF	LINEAR FOOT	RMC	RIGID METAL CONDUIT		
DOT&PF	DEPARTMENT OF TRANSPORTATION & PUBLIC FACILITIES	LS	LUMP SUM	ROW, R.O.W.	RIGHT OF WAY		
EA	EACH	LT	LEFT	RP	REFERENCE POINT		
EB	EASTBOUND	MIN.	MINIMUM	RT	RIGHT		
EOP	END OF PROJECT	ME	MATCH EXISTING	SB	SOUTHBOUND		
		MMA	METHYL METHACRYLATE				
		MUTCD	MANUAL ON UNIFORM TRAFFIC CONTROL DEVICES				

GENERAL NOTES:

- CONTRACTOR IS RESPONSIBLE FOR PROVIDING THEIR OWN STAGING AREA.
- CONTAIN ALL CONSTRUCTION WITHIN THE RIGHT-OF-WAY. DO NOT DISPOSE OF EXCESS MATERIAL WITHIN THE RIGHT-OF-WAY, UNLESS SPECIFICALLY CALLED FOR IN THE PLANS.
- DO NOT COVER JUNCTION BOXES OR POLE FOUNDATION BOLTS AND BASE PLATES WITH TOPSOIL.

THE FOLLOWING STANDARD PLANS APPLY TO THIS PROJECT:
 L-23.02, L-30.11, S-00.12, S-01.02, S-05.02, S-20.11, S-23.00, S-30.05, S-31.02, T-06.00, T-20.04, T-21.04, T-22.04, T-31.01



STATE OF ALASKA DEPARTMENT OF TRANSPORTATION AND PUBLIC FACILITIES
 6860 GLACIER HIGHWAY JUNEAU, AK 99811
 (907) 468-1783

JUNEAU: EGAN-YANDUKIN INTERSECTION IMPROVEMENTS

INDEX, ABBREVIATIONS & GENERAL NOTES

PLANS DEVELOPED BY: KINNEY ENGINEERING, LLC 3609 Arctic Blvd., Suite 400 Anchorage, Alaska 99503 (807) 346-2373 CERT. OF AUTH. NO. 1102
 DATE: 9/13/22 5:19 PM
 FILE: 00307_A3_LEGEND.dwg
 DESIGNED: JAM
 CHECKED: WW
 DRAFTED: AF

	RECOVERED	SET
BLM MONUMENT		
GLO MONUMENT		
USC&GS MONUMENT		
PRIMARY MONUMENT		
CENTERLINE MONUMENT IN CASING		
PRIMARY R.O.W. MONUMENT		
BEARING OBJECT		
MISCELLANEOUS MONUMENT		
LINE OF SIGHT MONUMENT		
CONCRETE R.O.W. MONUMENT		
BENCHMARK		
REBAR AND CAP		
REBAR		
IRON PIPE		
PK NAIL		
SPIKE		
HUB AND TACK		
CONSTRUCTION CENTERLINE		
MISCELLANEOUS CENTERLINE		
STATION EQUATION	$\frac{L}{48+97.23} \text{ POT BK} = \frac{O}{48+97.23} \text{ PC AHD}$	
PROJECT RIGHT-OF-WAY LINE		
EXISTING RIGHT-OF-WAY LINE		
EXISTING PROPERTY LINE		
CONTROLLED ACCESS LINE		
EXISTING EASEMENT LINE		
PROPOSED EASEMENT LINE		
PROPOSED CUT SLOPE LIMIT		
PROPOSED FILL SLOPE LIMIT		
SECTION LINE		
1/4 SECTION LINE		
1/16 SECTION LINE		
TOWNSHIP & RANGE LINE		
MEANDER LINE		

	EXISTING	PROPOSED
SANITARY SEWER (FLOW DIRECTION →)		
FUEL LINE		
GAS LINE		
WATER LINE		
METER, VALVE, FIRE HYDRANT		
EXISTING STORM DRAIN (FLOW DIRECTION →)		
PROPOSED STORM DRAIN		
FIBER OPTIC LINE		
DIRECT BURIAL TELEPHONE CABLE		
DIRECT BURIAL ELECTRIC CABLE		
ELECTRIC LINE (OVERHEAD)		
POWER POLE LINE		
JOINT USE POWER & TELEPHONE		
TELEPHONE POLE LINE		
POLE ANCHOR		
STUB POLE (POWER OR TELEPHONE)		
TELEPHONE DUCT		
TELEPHONE PEDESTAL		
BURIED CABLE MARKER		
PIPELINE MARKER OR VALVE		
CATCH BASIN OR DROP INLET		
MANHOLE		
SANITARY SEWER CLEAN OUT		
RIPRAP		
DITCH CENTERLINE		
HIGH TIDE LINE		
GRADE BREAK		
WATER VALVE		

	EXISTING	PROPOSED
ROADWAY/PAVEMENT EDGE		
FENCE		
CURB AND GUTTER		
DETECTABLE WARNINGS		
GUARDRAIL		
CULVERT PIPE		
SIGN		
MAILBOX		
RAILROAD TRACKS		
RAILROAD DEVICES		
TREE LINE		
WATER BOUNDARY		
ORDINARY HIGH WATER LINE		
FLOW CENTERLINE		
FLOW DIRECTION		
WETLANDS		
EXISTING BUILDINGS		
POST OR BOLLARD		
WELL OR MONITORING WELL		
SEPTIC PIPE		
FUEL TANK FILL PIPE/VENT		
SATELLITE DISH		
TEST HOLE		
CONIFER TREE		
DECIDUOUS TREE		
GRAVE		
THERMOSIPHON		
PARKING METER		
VEHICLE PLUG-IN		
DELINEATOR/GUIDE MARKER		

NO.	DATE	REVISION	STATE	PROJECT DESIGNATION	YEAR	SHEET NO.	TOTAL SHEETS
			ALASKA	0003261/SFHWY00307	2022	A3	A7

	EXISTING	PROPOSED
JUNCTION BOX, TYPE IA		
JUNCTION BOX, TYPE II		
JUNCTION BOX, TYPE III		
JUNCTION BOX, ABOVE GRADE		
SIGNAL FACE, VEHICULAR		
SIGNAL FACE, BACKPLATE		
SIGNAL FACE, LEFT TURN, BACKPLATE		
SIGNAL FACE, PEDESTRIAN		
LOOP DETECTOR		
VIDEO DETECTOR		
RADAR DETECTOR		
OPTICOM DETECTOR		
PAN, TILT, ZOOM CAMERA		
PEDESTRIAN PUSH BUTTON		
SIGNAL POST W/O MAST ARM		
SIGNAL POLE W/MAST ARM		
INTERCONNECT MANHOLE		
TRAFFIC CONTROLLER		
LOAD CENTER		
SIGN POWER ENCLOSURE		
LUMINAIRE		
LUMINAIRE REPLACEMENT ON EXISTING POLE AND MAST ARM		
RIGID METAL CONDUIT		
TRAFFIC SIGNAL INTERCONNECT		
RECESSED PAVEMENT MARKER		

H = HOUSE
 G = GARAGE
 M = MERCHANT/STORE
 B = BARN
 S = SHED
 P = PRIVY
 SS = SERVICE STATION
 W = WAREHOUSE

	PLANS DEVELOPED BY: KINNEY ENGINEERING, LLC	STATE OF ALASKA DEPARTMENT OF TRANSPORTATION AND PUBLIC FACILITIES 6860 GLACIER HIGHWAY, JUNEAU, AK 99811 (907) 465-1753
		JUNEAU: EGAN-YANDUKIN INTERSECTION IMPROVEMENTS LEGEND

PLANS DEVELOPED BY: KINNEY ENGINEERING, LLC, 3609 Arctic Blvd., Suite 400, Anchorage, Alaska 99503 (807) 346-2373 CERT. OF AUTH. NO. 1102
 DATE: 9/13/22 5:20 PM
 FILE: 00307_A4_SHEET_LAYOUT.dwg
 DESIGNED: JAM
 CHECKED: JMW
 DRAFTED: AF

NO.	DATE	REVISION	STATE	PROJECT DESIGNATION	YEAR	SHEET NO.	TOTAL SHEETS
			ALASKA	0003261/SFHWWY00307	2022	A4	A7



Record Drawings have been reviewed by the
 Project Engineer, and represent to the best of
 my knowledge, the project as constructed.

 PE *Shannon M. Kelly*

PLANS DEVELOPED BY: KINNEY ENGINEERING, LLC 	STATE OF ALASKA DEPARTMENT OF TRANSPORTATION AND PUBLIC FACILITIES 6860 GLACIER HIGHWAY, JUNEAU, AK 99811 (907) 465-1763 JUNEAU: EGAN-YANDUKIN INTERSECTION IMPROVEMENTS PROJECT OVERVIEW AND SHEET LAYOUT
---	--

DRAWING LOCATION: G:\VIA\SPRHWY002\1\5\SOURCE: DMS\BASEMAP\030507_SCS_090922.dwg
 DATE TIME: 1/7/2022 15:38
 LAYOUT: SCS1
 SCALE: 1"=100'
 SHEETS: 5
 REVISIONS: 1
 DESIGNED BY: J. YANDUKIN
 CHECKED BY: J. YANDUKIN
 DRAFTER: J. YANDUKIN

EGAN DRIVE DESIGN ALIGNMENT									
SEGMENT	STATION	NORTHING	EASTING	DISTANCE	BEARING	STATION	RADIUS	LENGTH	DELTA
L1	337+02.98	2384197.65	2520733.28	6363.52	S89° 44' 30"W	400+66.49			
C1	400+66.49	2384168.97	2514369.83			416+73.72	1909.72	1607.23	48°13'13"
L2	416+73.72	2384799.88	2512942.87	972.41	N42° 02' 17"W	426+46.14			
L3	426+46.14	2385522.09	2512291.72	970.54	N41° 53' 20"W	436+16.67			
C2	436+16.67	2386244.60	2511643.70			440+38.34	2864.59	421.67	8°26'02"
L4	440+38.34	2386578.12	2511386.32	1087.01	N33° 26' 28"W	451+25.35			
C3	451+25.35	2387485.18	2510787.29			459+90.31	1909.72	864.96	25°57'03"
L5	459+90.31	2388076.41	2510166.08	918.32	N59° 23' 30"W	469+08.63			

COORDINATES LISTED ABOVE HOLD OVER DISTANCE AND BEARING

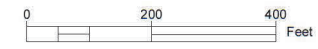

HORIZONTAL AND VERTICAL CONTROL STATEMENT:
 COORDINATES LISTED ARE NAD83(2011) ALASKA STATE PLANE COORDINATE SYSTEM ZONE 1 U.S. FEET.
 ALL BEARINGS AND DISTANCES ARE GRID AND DERIVED FROM TIES TO THE NATIONAL SPATIAL REFERENCE SYSTEM. THE VERTICAL DATUM IS NAVD88 DERIVED FROM ELLIPSOIDAL HEIGHTS AND NATIONAL GEODETIC SURVEY GEOID MODEL 12B.

DOT&PF 7 MILE BLDG

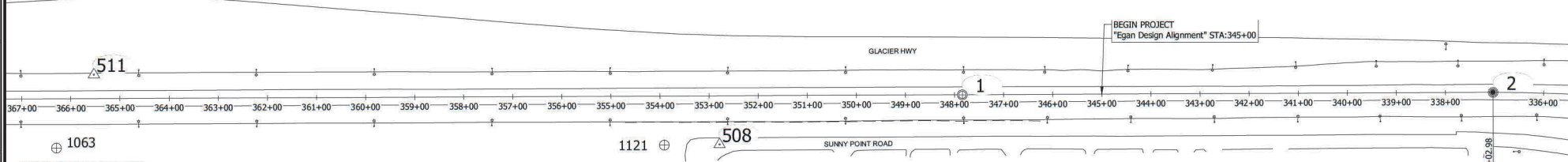

MONUMENT NOTES:
 1. IF ANY PAIR OF CONTROL POINTS DISAGREES FROM PUBLISHED VALUE BY MORE THAN 1:10,000 HORIZONTALLY OR VERTICALLY THEN A THIRD NETWORK POINT MUST BE TIED TO ASCERTAIN WHICH POINT IS IN ERROR OR HAS BEEN DISTURBED.
 2. WHETHER LISTED OR NOT, ALL PROPERTY MONUMENTS, PROPERTY MARKERS, CORNERS OR ACCESSORIES WHICH WILL BE DISTURBED OR BURIED SHALL BE REFERENCED PRIOR TO BEING DISTURBED, AND RE-ESTABLISHED IN THEIR ORIGINAL HORIZONTAL POSITION AND A RECORD OF MONUMENT FORM IN ACCORDANCE WITH (A.S.34.65.040) AND (A.S.19.10.260) SHALL BE SUBMITTED TO THE CONSTRUCTION ENGINEER FOR REVIEW PRIOR TO RECORDING. COORDINATE VALUES LISTED ARE FOR INFORMATIONAL PURPOSES AND SHOULD BE USED TO RESET MONUMENTS ONLY AS A LAST RESORT.
 3. WHEN POSSIBLE ALL ORIGINAL PRIMARY MONUMENTS SHALL BE SAVED AND RESET IN THEIR ORIGINAL HORIZONTAL POSITION AND A RECORD OF MONUMENT FORM IN ACCORDANCE WITH (A.S.34.65.040) AND (A.S.19.10.260) SHALL BE SUBMITTED TO THE CONSTRUCTION ENGINEER FOR REVIEW PRIOR TO RECORDING.
 4. RIGHT OF WAY LOCATION IS SHOWN FOR GRAPHICAL ORIENTATION PURPOSES ONLY. REFER TO ALASKA DOT&PF RIGHT OF WAY MAPS FOR RIGHT OF WAY INFORMATION.
 5. HORIZONTAL AND VERTICAL CONTROL MUST BE FIELD VERIFIED BY THE CONTRACTOR. DISCREPANCIES WILL BE REPORTED TO DOT&PF CONSTRUCTION PROJECT ENGINEER.

Existing Property					
Point #	Northing	Easting	Description	Station	Offset
1063	2384084.31	2517806.80	ALCAP3.25"_WETLANDS(BIRD)_1410-S_1984	366+29.94	100.15L
1121	2384090.33	2519045.08	ALCAP3.25"_MC77	353+91.65	99.72L

Centerline & Shoulder Monuments					
Point #	Northing	Easting	Description	Station	Offset
1	2384192.75	2519652.16	CL_MON_281+50_"KM-1"	347+84.12	0.03L
2	2384197.65	2520733.42	CL_MON_270+68.84_"KM-2"	337+02.84	0.00R
42	2384179.94	2516802.56	CL_MON_"O"_POT_310+00.00_"KM-42"	376+33.74	0.00R
93	2386244.94	2511643.39	CL_MON_DOH	436+17.14	0.01L
95	2384170.10	2514620.15	CL_MON_DOH	398+16.17	0.00R
343	2386341.83	2511485.22	GPS_BC/WELL_DOT/PF_ML-236	437+91.40	58.54L
360	2388482.03	2509301.92	GPS_SH_MON_DOT	N/A	N/A
1000	2386578.06	2511386.35	BC2.5"_CL MON IN CASE	440+38.27	0.01L
1001	2387485.10	2510787.36	BC2.5"_CL MON IN CASE	451+25.25	0.01R
1002	2388076.14	2510166.66	BC2.5"_CL MON IN CASE	459+89.68	0.06R
1132	2384799.50	2512942.97	CL_MON_BC2.5"_DOH_RTK	416+73.38	0.18L
1368	2388543.84	2509376.01	BC2.5"_DOH-CLMON IN CASE	469+08.30	0.03R

Existing CENTERLINE & SHOULDER monuments **SHALL BE PRESERVED IN PLACE AND ARE NOT INTENDED TO BE USED AS SURVEY CONTROL.** All monuments in these existing monument table shall be preserved and referenced prior to disturbance and replaced at their original horizontal position. **A RECORD OF MONUMENT FORM IN ACCORDANCE WITH A.S.34.65.040 SHALL BE SUBMITTED TO DOT&PF PROJECT ENGINEER FOR REVIEW PRIOR TO RECORDING FOR EACH MONUMENT.**

Survey Control Table						
Point #	Northing	Easting	Elevation	Description	Station	Offset
136	2388571.40	2509446.66	30.84	MAG/WASH	468+61.53	59.72R
500	2387226.40	2510850.97	29.92	MAG/WASH	448+74.32	89.47L
501	2386326.72	2511473.81	34.03	MAG/WASH	437+86.77	76.87L
502	2386522.68	2511533.03	29.21	MAG	439+07.10	88.96R
504	2385518.23	2512129.70	29.58	MAG	427+51.44	123.19L
505	2384174.53	2513688.91	26.91	MAG	407+23.29	109.63L
506	2385058.38	2512853.11	28.28	MAG	419+25.82	106.43R
508	2384091.78	2519157.65	33.35	MAG/WASH	352+79.07	98.77L
511	2384233.68	2517883.05	26.40	MAG/WASH	365+53.02	48.88R
512	2384227.13	2516628.85	26.64	MAG/WASH	378+07.24	47.98R
513	2388326.16	2509985.23	30.11	MAG/WASH	462+73.13	122.87R
514	2387923.50	2510249.23	28.61	MAG	458+33.92	83.14L
515	2384045.28	2514597.36	25.51	MAG/WASH	398+39.53	124.71L

All **SURVEY CONTROL** monuments in this table are provided strictly for survey control. Should any of them be destroyed during construction they **shall not** be replaced.

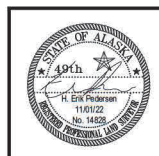

STATE OF ALASKA
 DEPARTMENT OF TRANSPORTATION
 AND PUBLIC FACILITIES
 6860 Glacier Highway Juneau Ak. 99801
 (907) 465-1763

**JUNEAU: EGAN-YANDUKIN
 INTERSECTION IMPROVEMENTS**

SURVEY CONTROL

NO.	DATE	REVISION	STATE	PROJECT DESIGNATION	YEAR	SHEET NO.	TOTAL SHEETS
			ALASKA	0003261/SFHWHY00307	2022	A6	A7

DRAWING LOCATION: G:\VIA\SFHWHY00307\SOURCE\DWG\BASEMAP\00307_SCS_080922.dwg
 DATE TIME: 11/7/2022 15:38
 LAYOUT: SCS2
 SCALE: XREFS:

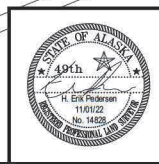
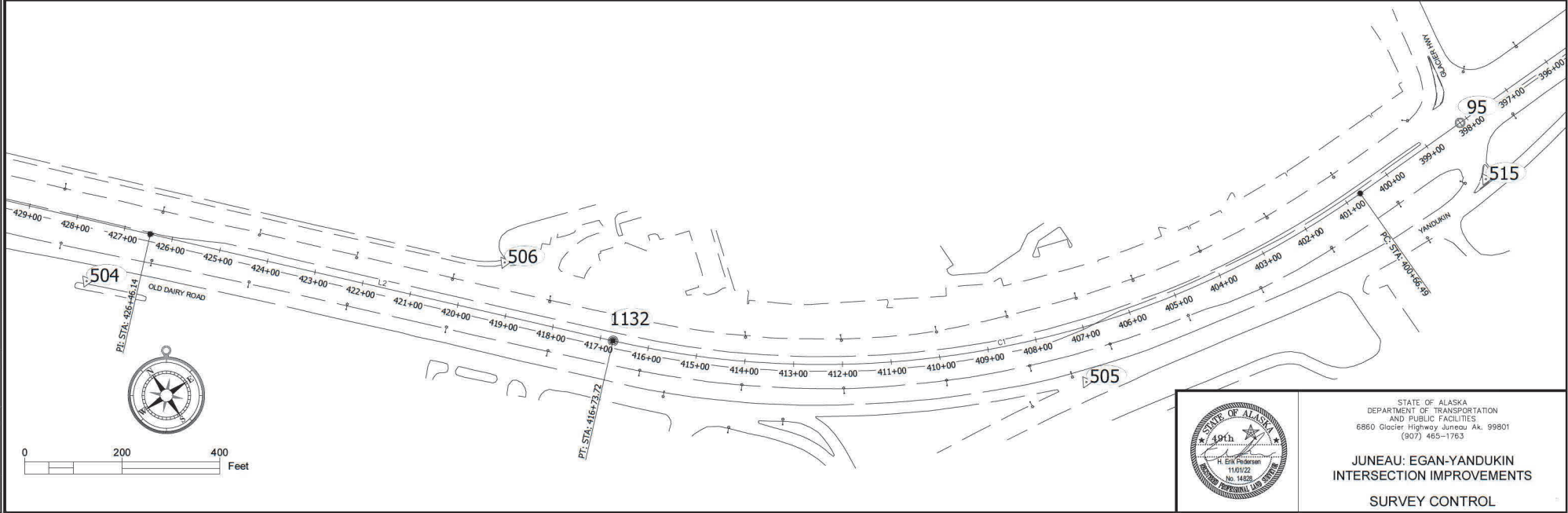
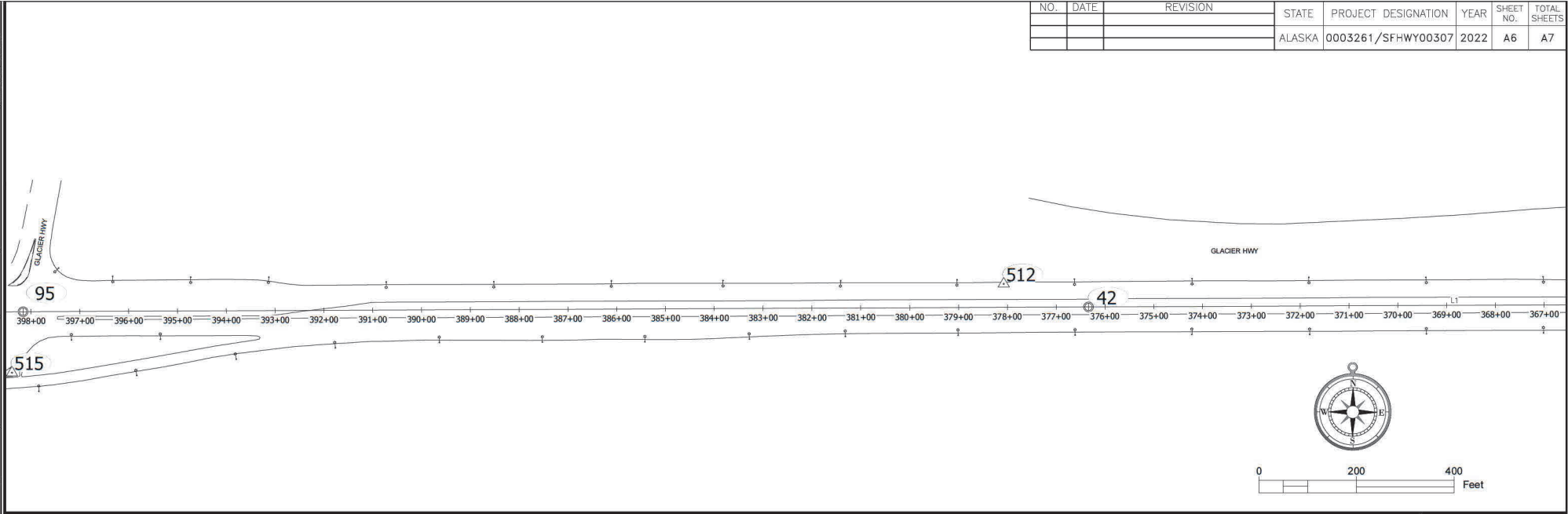

STATE OF ALASKA
 DEPARTMENT OF TRANSPORTATION
 AND PUBLIC FACILITIES
 6860 Glacier Highway Juneau Ak. 99801
 (907) 465-1763

**JUNEAU: EGAN-YANDUKIN
 INTERSECTION IMPROVEMENTS
 SURVEY CONTROL**

NO.	DATE	REVISION	STATE	PROJECT DESIGNATION	YEAR	SHEET NO.	TOTAL SHEETS
			ALASKA	0003261/SFHWY00307	2022	A7	A7

DRAWING LOCATION: G:\VIA\SFHWD\027\SV\SOURCE:DWG\BASEMAP\003261_SCS_080922.dwg
 DATE TIME: 11/17/2022 15:38
 LAYOUT: SCS3
 SCALE: XREFS
 DESIGNED: J. PARO
 CHECKED: J. PARO
 DRAFTED: J. PARO

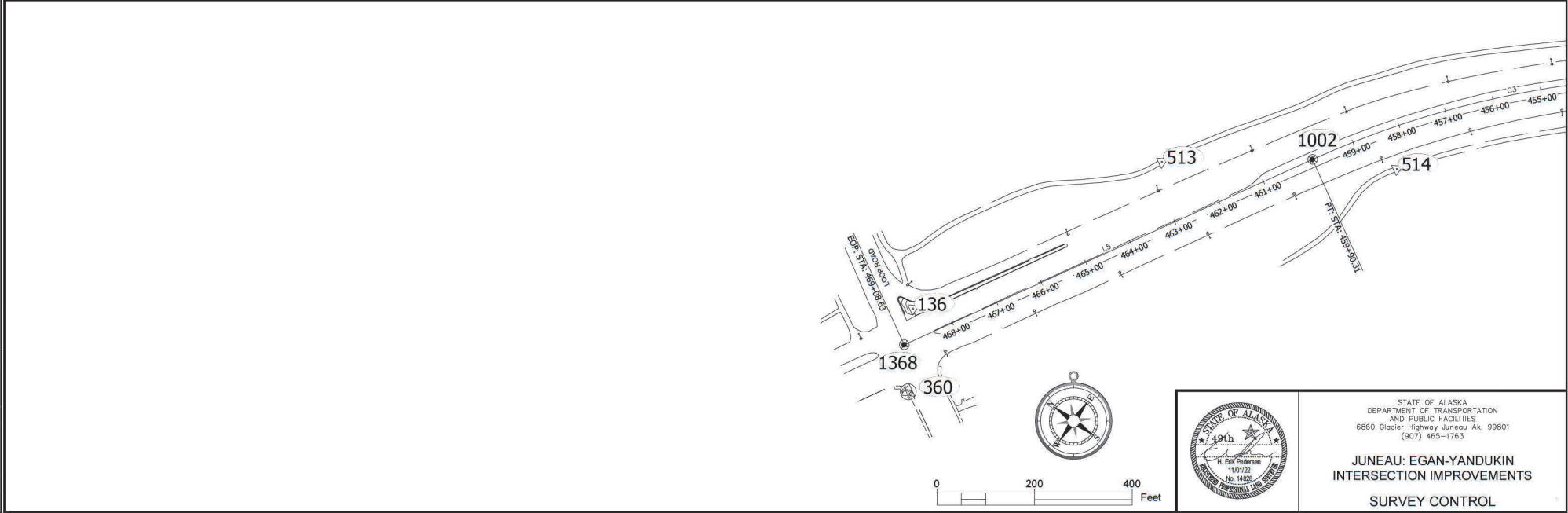
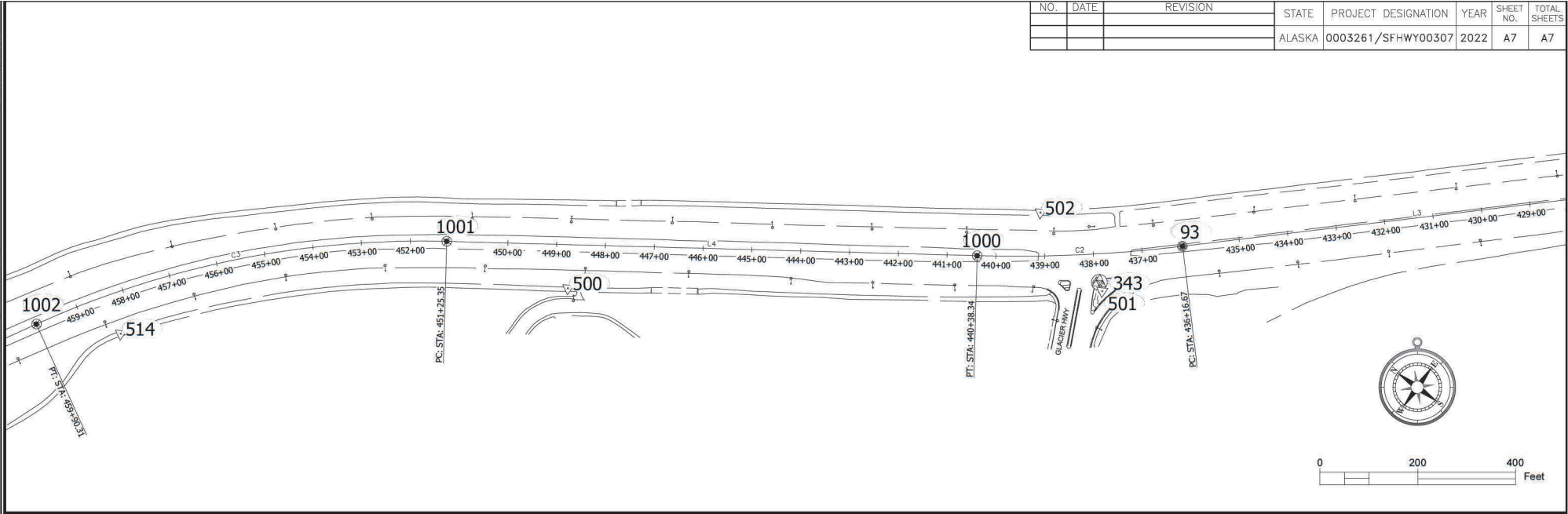

STATE OF ALASKA
 DEPARTMENT OF TRANSPORTATION
 AND PUBLIC FACILITIES
 6860 Glacier Highway Juneau Ak. 99801
 (907) 465-1763

**JUNEAU: EGAN-YANDUKIN
 INTERSECTION IMPROVEMENTS**
SURVEY CONTROL

NO.	DATE	REVISION	STATE	PROJECT DESIGNATION	YEAR	SHEET NO.	TOTAL SHEETS
1	9/14/23	NEW SHEET ADDED	ALASKA	0003261/SFHWHY00307	2022	B1	B1

TYPICAL SECTION NOTES

1. MINIMIZE PAVEMENT JOINTS. WHEN A JOINT IS REQUIRED, LOCATE IT AT CENTERLINE OR LANE EDGE LINE AS APPROVED BY THE ENGINEER.
2. COLD PLANING DEPTH MAY VARY AT RUTS, POTHOLES, AND OTHER FEATURES. THE INTENT IS TO PROVIDE A SMOOTH DRIVING SURFACE, MATCHING PAVEMENT TIE-IN POINTS AND AVOIDING SURFACE PONDING.

LEGEND	
①	1.5" HMA, SP; TYPE B
②	STE-1 TACK COAT

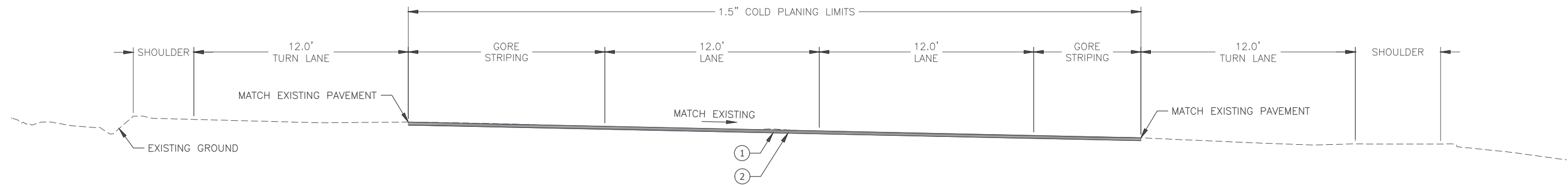

TYPICAL SECTION
 STA. 393+00 RT - STA. 397+75 RT

Record Drawings have been reviewed by the Project Engineer, and represent to the best of my knowledge, the project as constructed.

PE Shannon M. Kelly

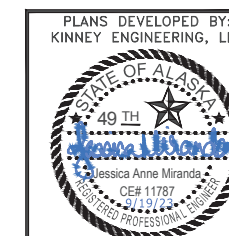

PLANS DEVELOPED BY:
 KINNEY ENGINEERING, LLC

STATE OF ALASKA DEPARTMENT OF
 TRANSPORTATION
 AND PUBLIC FACILITIES
 6860 GLACIER HIGHWAY, JUNEAU, AK 99811
 (907) 465-1763

**JUNEAU: EGAN-YANDUKIN
 INTERSECTION IMPROVEMENTS**

TYPICAL SECTION

PLANS DEVELOPED BY: KINNEY ENGINEERING, LLC, 3609 Arctic Blvd., Suite 400, Anchorage, Alaska 99503 (807) 346-2373 CERT. OF AUTH. NO. 1102
 FILE: 00307_C1_E00.dwg DATE: 9/13/22 9:20 PM LAYOUT: C1 DESIGNED: JAM CHECKED: JWM DRAFTED: AF

NO.	DATE	REVISION	STATE	PROJECT DESIGNATION	YEAR	SHEET NO.	TOTAL SHEETS
			ALASKA	0003261/SFHWHY00307	2022	C1	C1

ESTIMATE OF QUANTITIES			
ITEM NUMBER	ITEM DESCRIPTION	PAY UNIT	QUANTITY
201.2002.0000	INVASIVE PLANT SURVEY	LS	ALL REQUIRED
201.2002.0000	INVASIVE PLANT SPECIES CONTROL, REMOVAL, AND DISPOSAL	CS	ALL REQUIRED
202.0002.0000	REMOVAL OF PAVEMENT	SY	30 37.44
615.0001.0000	STANDARD SIGN	SF	127.39 127.40
615.0005.0000	DELINEATOR, FLEXIBLE	EACH	2
615.0006.0000	SALVAGE SIGN	EACH	7 6
618.0002.0000	SEEDING	LB	3.4
620.0001.0000	TOPSOIL	SY	296 37.40
640.0001.0000	MOBILIZATION AND DEMOBILIZATION	LS	ALL REQUIRED
642.0001.0000	CONSTRUCTION SURVEYING	LS	ALL REQUIRED
643.0002.0000	THREE PERSON SURVEY PARTY	HR	40
643.0002.0000	TRAFFIC MAINTENANCE	LS	ALL REQUIRED
643.0003.0000	PERMANENT CONSTRUCTION SIGNS	LS	ALL REQUIRED
643.0003.0000	TRAFFIC PRICE ADJUSTMENT	CS	ALL REQUIRED
643.0025.0000	TRAFFIC CONTROL	CS	ALL REQUIRED
643.0002.0000	FLAGGING	CS	ALL REQUIRED
658.0001.0000	EROSION, SEDIMENT AND POLLUTION CONTROL WITHOUT CGP COVERAGE	LS	ALL REQUIRED
658.0002.0000	EGOP CHANGES BY DIRECTIVE	CS	ALL REQUIRED
660.0002.0000	FLASHING BEACON SYSTEM COMPLETE, LED YIELD	LS	ALL REQUIRED
660.0003.0000	HIGHWAY LIGHTING SYSTEM COMPLETE, NB EGAN DRIVE	LS	ALL REQUIRED
660.2013.0000	VMS - RADAR SPEED SIGN	EACH	2
661.0007.0000	MODIFY LOAD CENTER	LS	ALL REQUIRED
670.0008.0000	RECESSED PAVEMENT MARKER	EACH	21 23
670.0014.0000	REMOVAL OF PAVEMENT MARKINGS	LS	ALL REQUIRED
670.2002.0000	MMA PAVEMENT MARKINGS, INLAID	LS	ALL REQUIRED
670.0014.0000	SAND SEAL EXISTING PAVEMENT JOINT (CO 4)	LS	ALL REQUIRED

NOT USED

NOT USED

NOT USED

NOT USED

NOT USED

Record Drawings have been reviewed by the Project Engineer, and represent to the best of my knowledge, the project as constructed.

PE Shannon M. Kelly



STATE OF ALASKA DEPARTMENT OF TRANSPORTATION AND PUBLIC FACILITIES
 6860 GLACIER HIGHWAY JUNEAU, AK 99811
 (907) 465-1753
 JUNEAU: EGAN-YANDUKIN INTERSECTION IMPROVEMENTS
 ESTIMATE OF QUANTITIES

NO.	DATE	REVISION	STATE	PROJECT DESIGNATION	YEAR	SHEET NO.	TOTAL SHEETS
			ALASKA	0003261/SFHWY00307	2022	D1	D1

202.0002.0000 REMOVAL OF PAVEMENT				
SHEET	BEGIN STATION	END STATION	QUANTITY (SY)	REMARKS
H2	397+42	397+50	3 4.692	NB LEFT TURN MEDIAN
H2	398+57	399+10	27 32.745	SB LEFT TURN MEDIAN
TOTAL:			30 37.44	

618.0002.0000 SEEDING & 620.0001.0000 TOPSOIL						
BEGIN		END		618.0002.0000 SEEDING QUANTITY (LB)	620.0001.0000 TOPSOIL QUANTITY (SY)	REMARKS
STATION	OFFSET	STATION	OFFSET			
397+42	LT	397+50	LT	0.1	2.0	NB LEFT TURN MEDIAN
398+57	RT	399+10	RT	0.3	27.0	SB LEFT TURN MEDIAN
371+82	RT	371+82	RT	1.0	89.0	ELECTRICAL TRENCH
397+27	RT	397+36	RT	1.0	89.0	ELECTRICAL TRENCH
430+10	LT	430+26	LT	1.0	89.0	ELECTRICAL TRENCH
TOTAL				3.4	296.0 37.40 SY	

Record Drawings have been reviewed by the Project Engineer, and represent to the best of my knowledge, the project as constructed.

PE

Shannon M. Kelly



STATE OF ALASKA DEPARTMENT OF TRANSPORTATION AND PUBLIC FACILITIES
 6860 GLACIER HIGHWAY, JUNEAU, AK 99811
 (907) 465-1753
JUNEAU: EGAN-YANDUKIN INTERSECTION IMPROVEMENTS
 SUMMARY TABLES

PLANS DEVELOPED BY: KINNEY ENGINEERING, LLC, 3609 Arctic Blvd., Suite 400, Anchorage, Alaska 99503, (807) 346-2373 CERT. OF AUTH. NO. 1102
 DATE: 9/13/22 9:51 PM
 FILE: 00307_G1 GRADING.dwg
 DESIGNED: JAM
 CHECKED: JWM
 DRAFTED: AF

NO.	DATE	REVISION	STATE	PROJECT DESIGNATION	YEAR	SHEET NO.	TOTAL SHEETS
			ALASKA	0003261/SFHWHY00307	2022	G1	G1

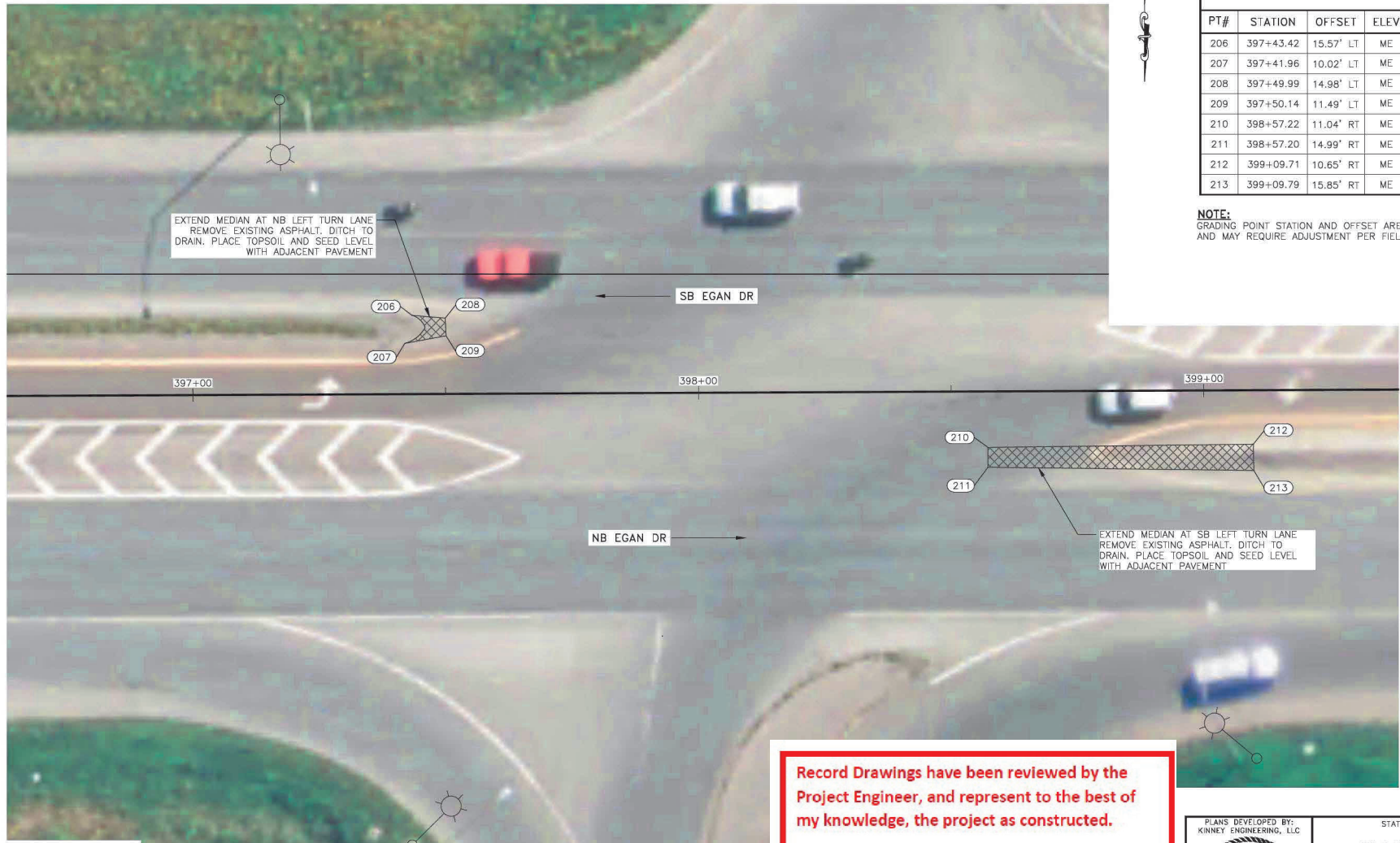

PT#	STATION	OFFSET	ELEV	DESCRIPTION
206	397+43.42	15.57' LT	ME	PI, SAWCUT
207	397+41.96	10.02' LT	ME	PI, SAWCUT
208	397+49.99	14.98' LT	ME	PI, SAWCUT
209	397+50.14	11.49' LT	ME	PI, SAWCUT
210	398+57.22	11.04' RT	ME	PI, SAWCUT
211	398+57.20	14.99' RT	ME	PI, SAWCUT
212	399+09.71	10.65' RT	ME	PI, SAWCUT
213	399+09.79	15.85' RT	ME	PI, SAWCUT

NOTE:
 GRADING POINT STATION AND OFFSET ARE APPROXIMATE AND MAY REQUIRE ADJUSTMENT PER FIELD CONDITIONS.

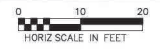
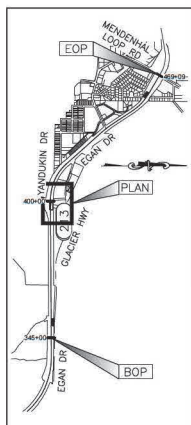

INTERSECTION GRADING PLAN

Record Drawings have been reviewed by the Project Engineer, and represent to the best of my knowledge, the project as constructed.

PE Shannon M. Kelly



PLANS DEVELOPED BY:
 KINNEY ENGINEERING, LLC
 STATE OF ALASKA DEPARTMENT OF TRANSPORTATION AND PUBLIC FACILITIES
 6860 GLACIER HIGHWAY, JUNEAU, AK 99811
 (907) 465-1763
JUNEAU: EGAN-YANDUKIN INTERSECTION IMPROVEMENTS
 INTERSECTION GRADING PLAN

PLANS DEVELOPED BY: KINNEY ENGINEERING, LLC, 3609 Arctic Blvd., Suite 400 Anchorage, Alaska 99503 (907) 346-2373 CERT. OF AUTH. NO. 1102
 FILE: 00307-H1-TRAF-LAND AND NOTES.dwg DATE: 9/13/22 4:17 PM DESIGNED: JAM CHECKED: WNW DRAFTED: AF

NO.	DATE	REVISION	STATE	PROJECT DESIGNATION	YEAR	SHEET NO.	TOTAL SHEETS
			ALASKA	0003261/SFHWHY00307	2022	H1	H11

SIGNING & STRIPING NOTES:

1. ALL STATION LOCATIONS FOR SIGN INSTALLATION ARE APPROXIMATE. INSTALL SIGNS AT LOCATIONS AS DIRECTED BY THE ENGINEER.
3. FABRICATE ALL SIGNS FROM 0.125" THICK ALUMINUM SHEETING, UNLESS STATED ELSEWHERE.
4. FABRICATE CUSTOM SIGNS ACCORDING TO THE DETAILS IN THE PLANS OR THE SHOP DRAWINGS INCLUDED IN THE APPENDICES OF PART 4, CONTRACT PROVISIONS AND SPECIAL PROVISIONS. TRIM THE CORNERS OF ALL SIGNS TO THE RADIUS SHOWN ON EACH SHOP DRAWING.
5. ERECT NEW SIGNS BEFORE REMOVAL OF EXISTING SIGNS WITH SIMILAR MESSAGE. NOTIFY THE ENGINEER A MINIMUM OF 14 DAYS PRIOR TO BEGINNING SIGN REMOVAL AND SALVAGE OR DISPOSAL ACTIVITIES.
6. SELECTIVE AND HAND CLEARING SHALL BE PERFORMED AT THE DISCRETION OF THE ENGINEER, IN ACCORDANCE WITH SECTION 201, UPSTREAM OF ALL SIGN INSTALLATION LOCATIONS TO ACHIEVE MINIMUM SIGN VISIBILITY REQUIREMENTS. THIS WORK SHALL BE SUBSIDIARY TO THE SIGN INSTALLATION ITEMS AND WORK.

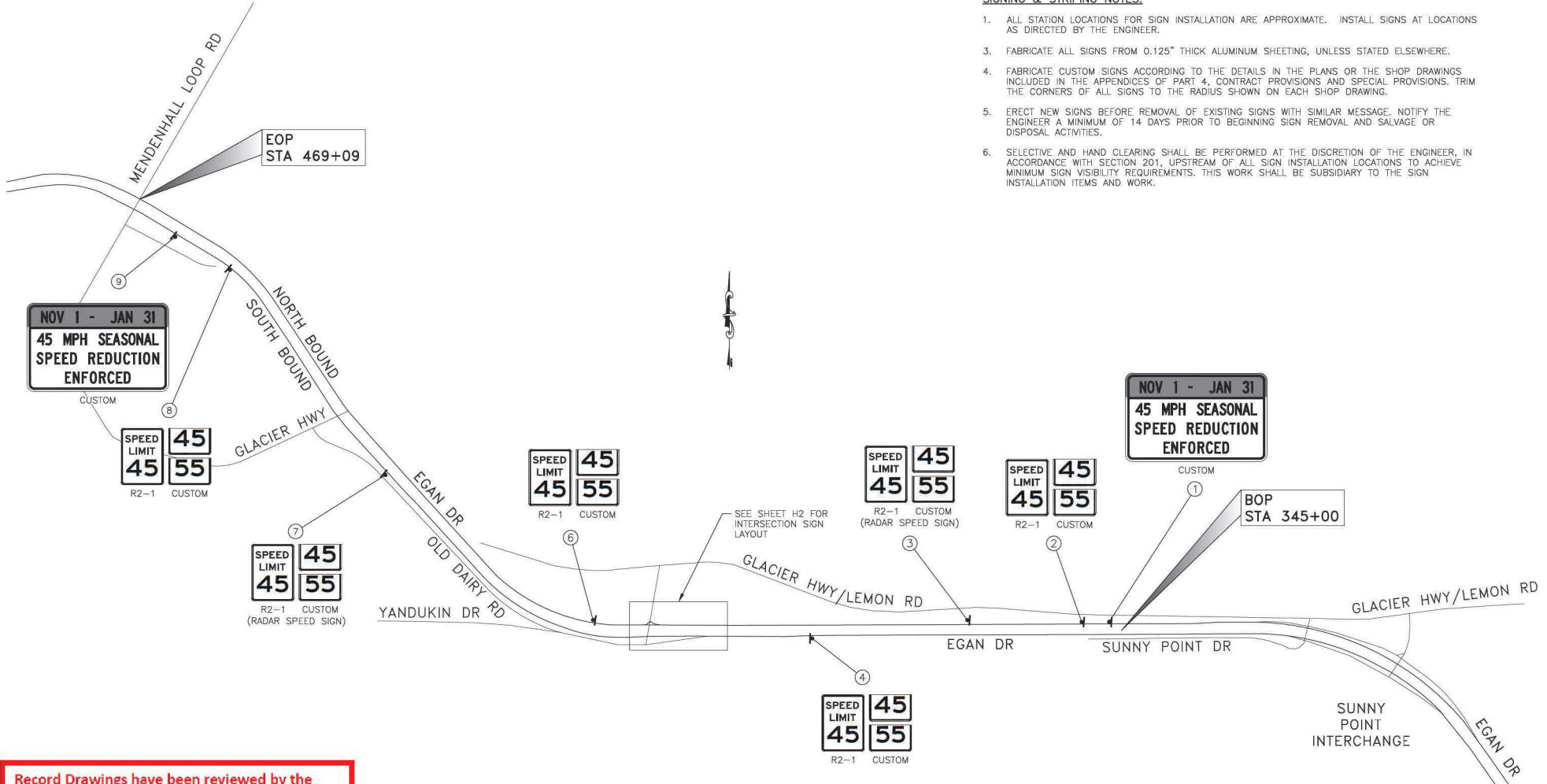

Record Drawings have been reviewed by the Project Engineer, and represent to the best of my knowledge, the project as constructed.

 PE Shannon M. Kelly

PROPOSED SIGN LAYOUT

PLANS DEVELOPED BY: KINNEY ENGINEERING, LLC 	STATE OF ALASKA DEPARTMENT OF TRANSPORTATION AND PUBLIC FACILITIES 6860 GLACIER HIGHWAY, JUNEAU, AK 99811 (907) 465-1753 JUNEAU: EGAN-YANDUKIN INTERSECTION IMPROVEMENTS PROPOSED SIGN LAYOUT
---	---

PLANS DEVELOPED BY: KINNEY ENGINEERING, LLC 3609 Arctic Blvd., Suite 400 Anchorage, Alaska 99503 (907) 346-2373 CERT. OF AUTH. NO. 1102
 FILE: 00307-112-HB-PLAN SHEETS.dwg DATE: 9/13/22 9:21 PM LAYOUT: H2 DESIGNED: JAM CHECKED: WJW DRAFTED: AF

PAINTED TRAFFIC MARKINGS SUMMARY

SYMBOL	DESCRIPTION	PATTERN	QUANTITY
A	4" SOLID WHITE		793 LF
B	4" SOLID YELLOW		1,131 LF
C	4" WHITE SKIP LINE (10' STRIP/30' SKIP PATTERN)		983 LF
D	8" WHITE WIDE DOTTED LINE (2' STRIPE / 6' SKIP PATTERN)		383 LF
E	18" SOLID WHITE BUFFER STRIPE**		2,482 LF OF 8" WHITE SOLID & 1,880 SF OF 18" WHITE SOLID
F	18" YELLOW WHITE BUFFER STRIPE*		80 SF
G	TURNING LANE-USE ARROW*		5 EA
H	YIELD LINE**		15 SF

* ALASKA STANDARD PLAN
 ** SEE SHEET H3

TRAFFIC MARKING NOTES:

- ALL PROPOSED PAVEMENT MARKINGS SHALL BE INLAID METHYL METHACRYLATE (MMA), UNLESS OTHERWISE NOTED IN THE PLANS.
- IF THE NEW AND EXISTING PAVEMENT MARKINGS ARE NOT ALIGNED AT MATCH LINE, TRANSITION BETWEEN THE TWO USING A 100:1 TAPER ON THE NEW PAVEMENT.
- REMOVE ALL EXISTING PAVEMENT MARKINGS NOT COINCIDING WITH THE NEW MARKINGS. USE INFRARED HEATING TECHNOLOGY TO REMOVE GROOVES LEFT BY EXISTING MMA MARKINGS ONLY WITHIN THE NEW THROUGH LANES.
- DIMENSIONS REFER TO THE CENTER OF LANE STRIPE OR EDGE OF PAVEMENT.
- RECESSED PAVEMENT MARKERS SHALL BE DOUBLE SIDED AND MATCH THE COLOR OF THE PAVEMENT MARKING THEY SUPPLEMENT.

Record Drawings have been reviewed by the Project Engineer, and represent to the best of my knowledge, the project as constructed.
 PE *Shannon M. Kelly*

NO.	DATE	REVISION	STATE	PROJECT DESIGNATION	YEAR	SHEET NO.	TOTAL SHEETS
			ALASKA	0003261/SFHWY00307	2022	H2	H11

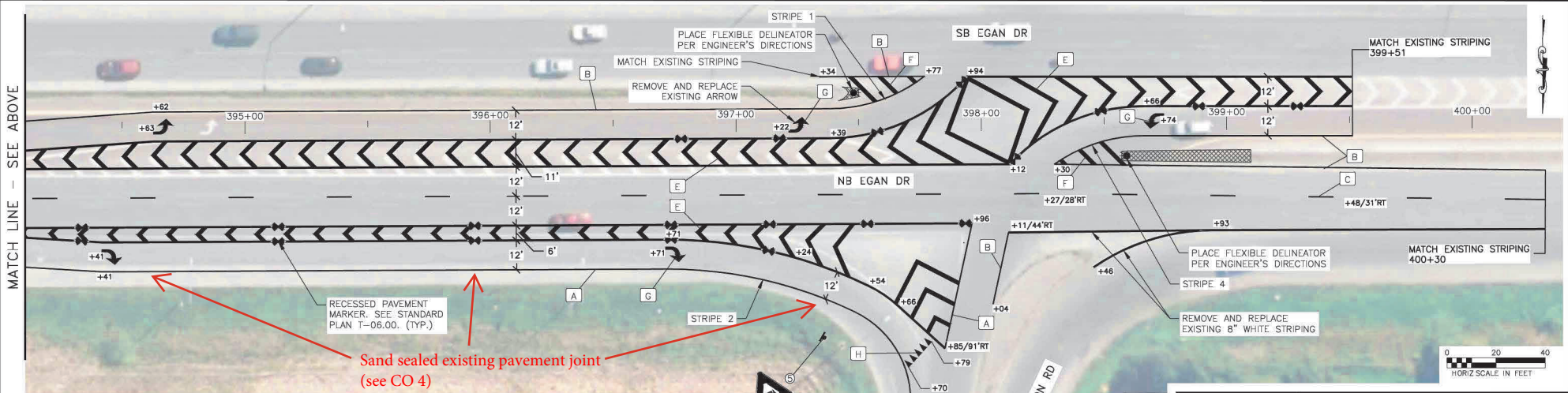
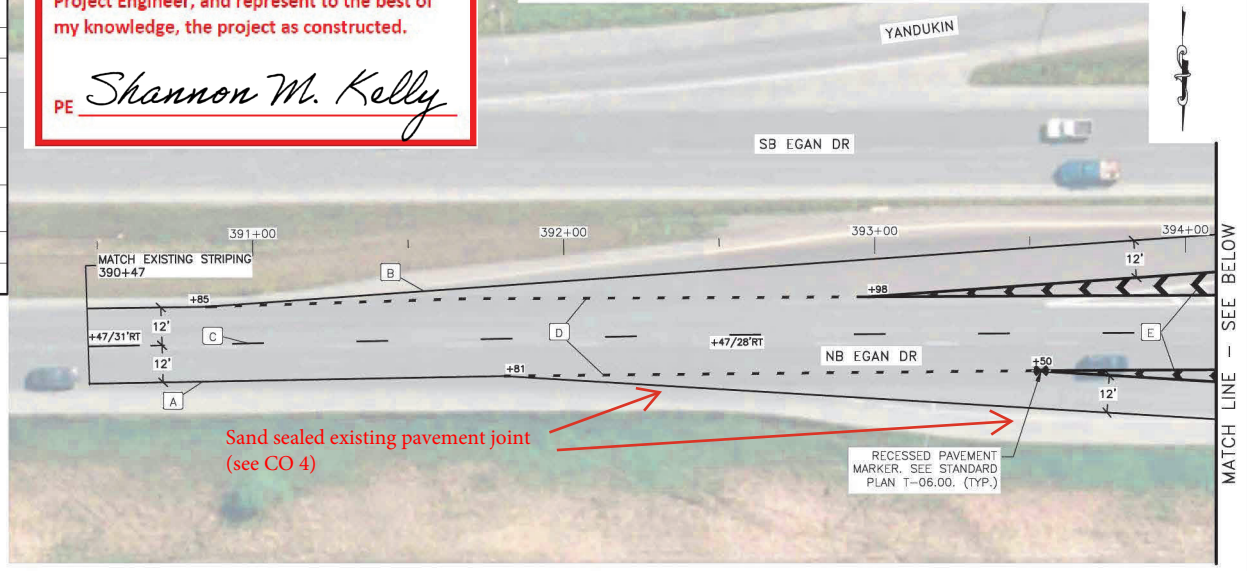

PAVEMENT MARKING TABLE

STRIPE	BEGIN	END	RADIUS (FT)	RADIUS POINT
1	397+38.59, 6.73' LT	397+76.96, 19.78' LT	63'	397+38.56, 69.73' LT
2	396+71.15, 58.30' RT	397+48.37, 76.22' RT	175'	396+71.22, 233.30' RT
3	397+48.37, 76.22' RT	397+70.19, 118.67' RT	40'	397+30.73, 112.13' RT
4	398+29.76, 16.28' RT	398+66.27, 4.82' RT	63'	398+65.98, 67.82' RT

PLANS DEVELOPED BY:
 KINNEY ENGINEERING, LLC

STATE OF ALASKA DEPARTMENT OF TRANSPORTATION AND PUBLIC FACILITIES
 6860 GLACIER HIGHWAY JUNEAU, AK 99811
 (907) 468-1783

JUNEAU: EGAN-YANDUKIN INTERSECTION IMPROVEMENTS

SIGNING AND STRIPING PLAN

0 20 40
 HORIZ SCALE IN FEET

PLANS DEVELOPED BY: KINNEY ENGINEERING, LLC 3009 Arctic Blvd., Suite 400 Anchorage, Alaska 99503 (807) 346-2373 CERT. OF AUTH. NO. 1102
 DATE: 9/13/22 9:51 PM
 FILE: 00307-H3-SIGN DETAILS.dwg
 DESIGNED: JAM
 CHECKED: WNW
 DRAFTED: AF

Record Drawings have been reviewed by the
 Project Engineer, and represent to the best of
 my knowledge, the project as constructed.
 PE *Shannon M. Kelly*

NO.	DATE	REVISION	STATE	PROJECT DESIGNATION	YEAR	SHEET NO.	TOTAL SHEETS
			ALASKA	0003261/SFHWHY00307	2022	H3	H11

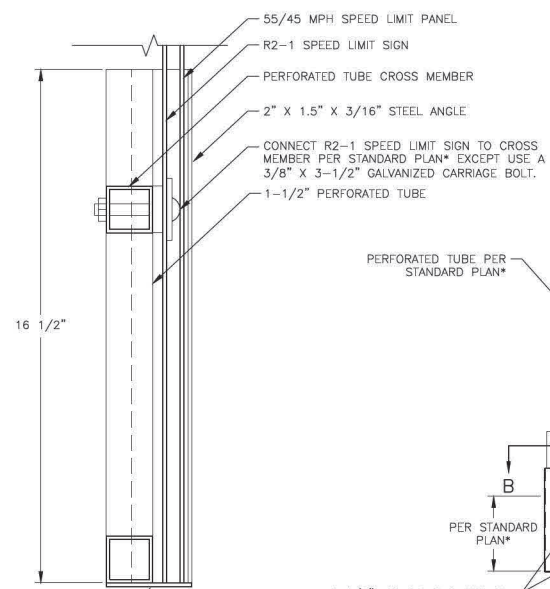

SECTION VIEW A-A

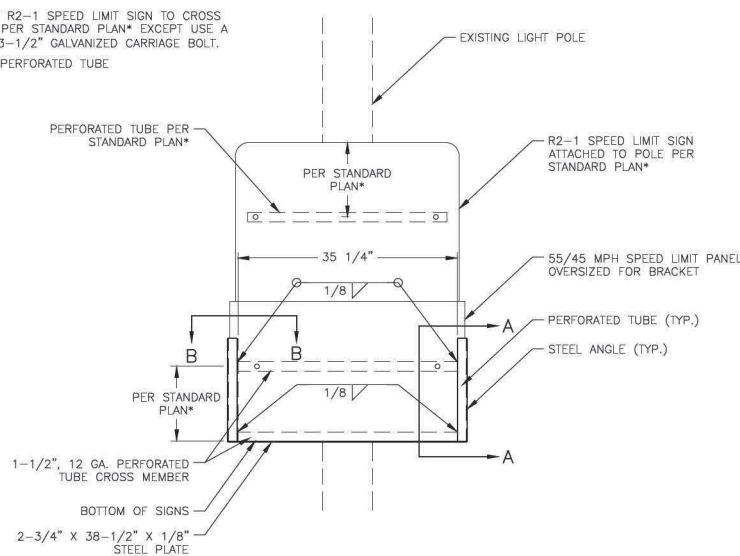

ELEVATION

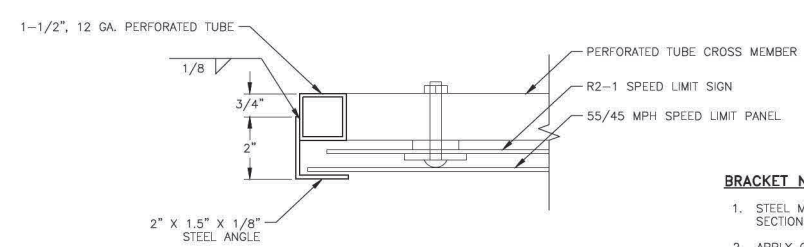

SECTION VIEW B-B

SEASONAL SPEED LIMIT SIGN BRACKET

- BRACKET NOTES:**
1. STEEL MEMBERS SHALL BE GALVANIZED PER SECTION 716 OF THE SPECIFICATIONS
 2. APPLY COLD GALVANIZING PAINT TO AREAS OF DAMAGED COATING AND TO WELDS.

* STANDARD PLAN S-23.00

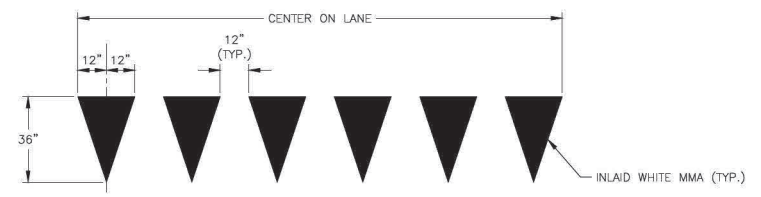

YIELD LINE DETAIL

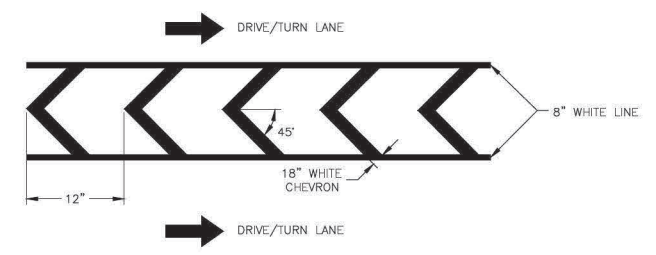

BUFFER STRIPING DETAIL

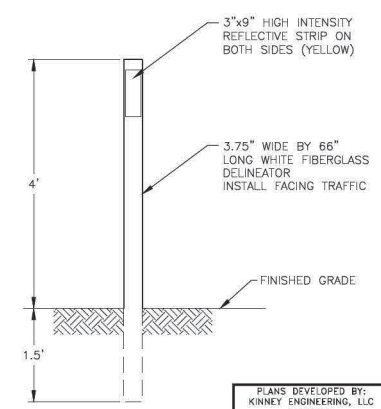

ELEVATION

FLEXIBLE DELINEATOR DETAIL
NTS



STATE OF ALASKA DEPARTMENT OF
 TRANSPORTATION
 AND PUBLIC FACILITIES
 6860 GLACIER HIGHWAY, JUNEAU, AK 99811
 (907) 465-1753
**JUNEAU: EGAN-YANDUKIN
 INTERSECTION IMPROVEMENTS**
 SIGNING AND STRIPING DETAILS

PLANS DEVELOPED BY: KINNEY ENGINEERING, LLC, 3009 Arctic Blvd., Suite 400, Anchorage, Alaska 99503 (907) 345-2373 CERT. OF AUTH. NO. 1102
 FILE: 00087-H4-SIGN SUMMARY.dwg
 DATE: 9/13/22 5:12 PM
 LAYOUT: H4
 DESIGNED: JAM
 CHECKED: WW
 DRAFTED: AF

NO.	DATE	REVISION	STATE	PROJECT DESIGNATION	YEAR	SHEET NO.	TOTAL SHEETS
			ALASKA	0003261/SFHWHY00307	2022	H4	H11

SIGN SUMMARY												
SHEET	POST NO.	LOCATION	TYPE	LEGEND	SIZE		AREA (SF)	SIGN FACES	POST(S) NO., SIZE, & TYPE	FRAMED		REMARKS
					WIDTH (IN)	HEIGHT (IN)				YES	NO	
H1	1	351+84 RT	CUSTOM	SEASONAL SPEED REDUCTION MESSAGE SIGN	48	30	10.00	E		X		INSTALL ON LIGHT POLE
H1	2	365+01 RT	R2-1	45 MPH SPEED LIMIT	36	48	12.00	E	N/A	X		INSTALL ON LIGHT POLE
H1			CUSTOM	55 / 45 PANEL	37.75	22.5	5.90					
H1	3	371+62 RT	R2-1	45 MPH SPEED LIMIT	36	48	12.00	E	N/A	X		INSTALL ON RADAR SPEED SIGN POLE
H1			CUSTOM	55 / 45 PANEL	37.75	22.5	5.90					
H1	4	381+32 LT	R2-1	45 MPH SPEED LIMIT	36	48	12.00	W	N/A	X		INSTALL ON LIGHT POLE
H1			CUSTOM	55 / 45 PANEL	37.75	22.5	5.90					
H2	5	397+36 RT	R1-2	YIELD (LED EMBEDDED)	48	48		SE	SEE H9			LED EMBEDDED SIGN
H1	6	404+17 RT	R2-1	45 MPH SPEED LIMIT	36	48	12.00	E	N/A	X		INSTALL ON LIGHT POLE
H1			CUSTOM	55 / 45 PANEL	37.75	22.5	5.90					
H1	7	430+26 LT	R2-1	45 MPH SPEED LIMIT	36	48	12.00	NW	N/A	X		INSTALL ON RADAR SPEED SIGN POLE
H1			CUSTOM	55 / 45 PANEL	37.75	22.5	5.90					
H1	8	456+93 LT	R2-1	45 MPH SPEED LIMIT	36	48	12.00	NW	N/A	X		INSTALL ON LIGHT POLE
H1			CUSTOM	55 / 45 PANEL	37.75	22.5	5.90					
H1	9	459+14 LT	CUSTOM	SEASONAL SPEED REDUCTION MESSAGE SIGN	48	30	10.00	NW		X		INSTALL ON LIGHT POLE
					TOTAL		127.39					

127.40 TOTAL

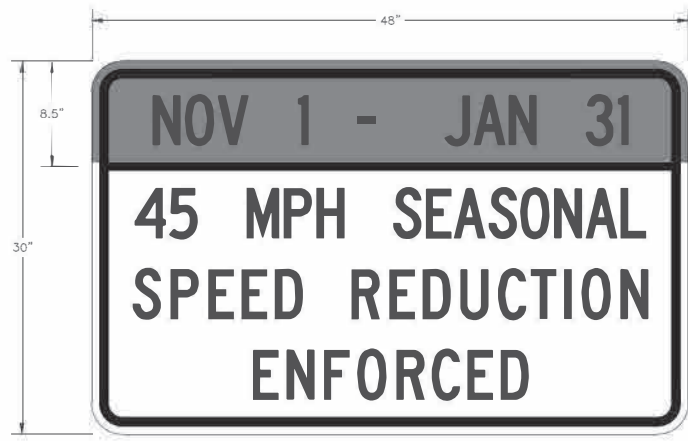

SEASONAL SPEED REDUCTION MESSAGE SIGN

SEASONAL SPEED REDUCTION MESSAGE SIGN NOTES:

1. LOWER BACKGROUND COLOR IS WHITE. UPPER BACKGROUND COLOR IS YELLOW.
2. SIGN HAS 4" BLACK LETTERING.
3. BORDER COLOR IS BLACK.

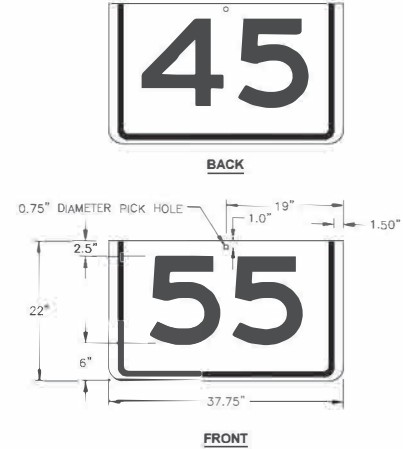

SPEED LIMIT PANEL

SPEED LIMIT PANEL NOTES:

1. PANEL IS DOUBLE-SIDED WITH 55 ONE SIDE AND 45 ON THE OTHER.
2. PANEL TEXT, COLORS, AND LAYOUT TO MATCH STANDARD SIGN R2-1 UNLESS OTHERWISE NOTED.
3. ADHERE REFLECTIVE SHEETING TO PANEL SO THAT THE BORDERS LINE UP WITH THE R2-1 SIGNS.
4. FOR EACH SPEED LIMIT PANEL, PROVIDE ONE UTILITY HOOK WITH AN EXTENDABLE POLE CAPABLE OF HOLDING 12 LBS AT 10 FEET EXTENDED.

SALVAGE SIGN SUMMARY			
LOCATION	ASDS CODE	LEGEND	REMARKS
342+74 RT	R2-1	55 MPH SPEED LIMIT	
371+82 RT	R2-1	55 MPH SPEED LIMIT	
381+32 LT	R2-1	55 MPH SPEED LIMIT	Did not exist (SMK)
397+43 RT	R2-1	YIELD	
404+17 RT	R2-1	55 MPH SPEED LIMIT	
430+15 LT	R2-1	55 MPH SPEED LIMIT	
466+42 LT	R2-1	55 MPH SPEED LIMIT	

6 TOTAL

Record Drawings have been reviewed by the Project Engineer, and represent to the best of my knowledge, the project as constructed.

 PE *Shannon M. Kelly*



STATE OF ALASKA DEPARTMENT OF TRANSPORTATION AND PUBLIC FACILITIES
 8860 GLACIER HIGHWAY, JUNEAU, AK 99811
 (907) 455-1753
JUNEAU: EGAN-YANDUKIN INTERSECTION IMPROVEMENTS
 SIGN SUMMARY

NO.	DATE	REVISION	STATE	PROJECT DESIGNATION	YEAR	SHEET NO.	TOTAL SHEETS
			ALASKA	0003261/SFHWHY00307	2022	H5	H11

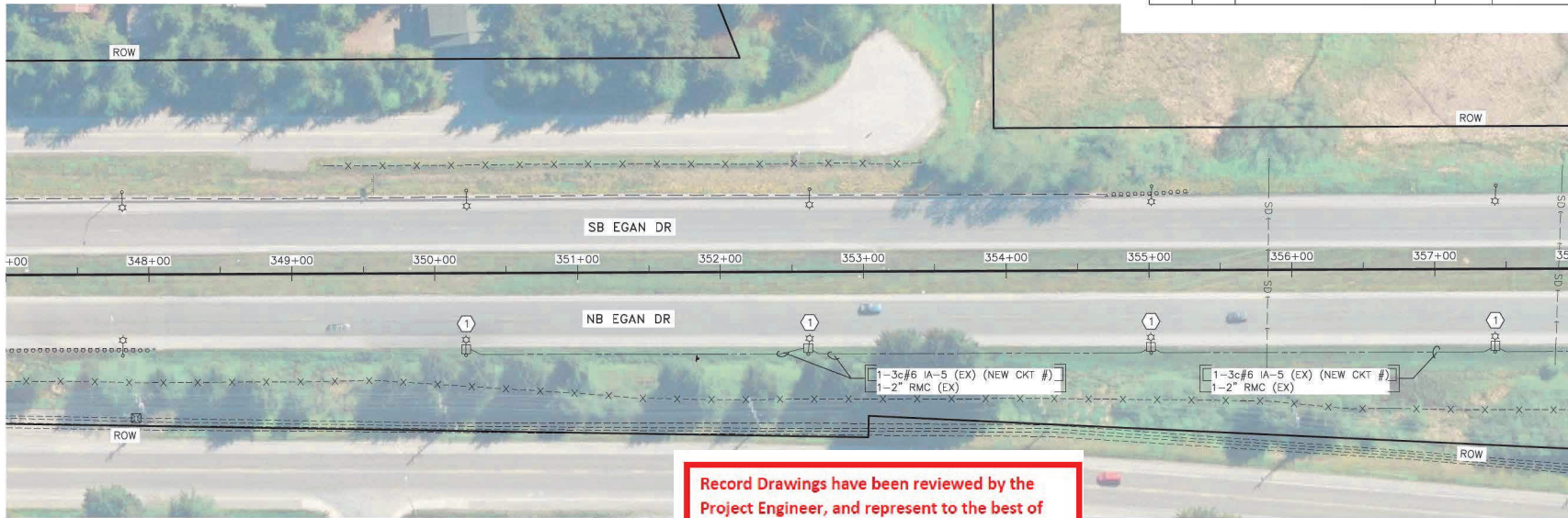

MATCH LINE SEE BELOW

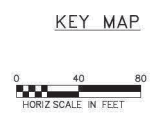
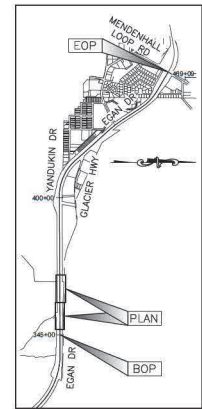

Record Drawings have been reviewed by the Project Engineer, and represent to the best of my knowledge, the project as constructed.

PE *Shannon M. Kelly*

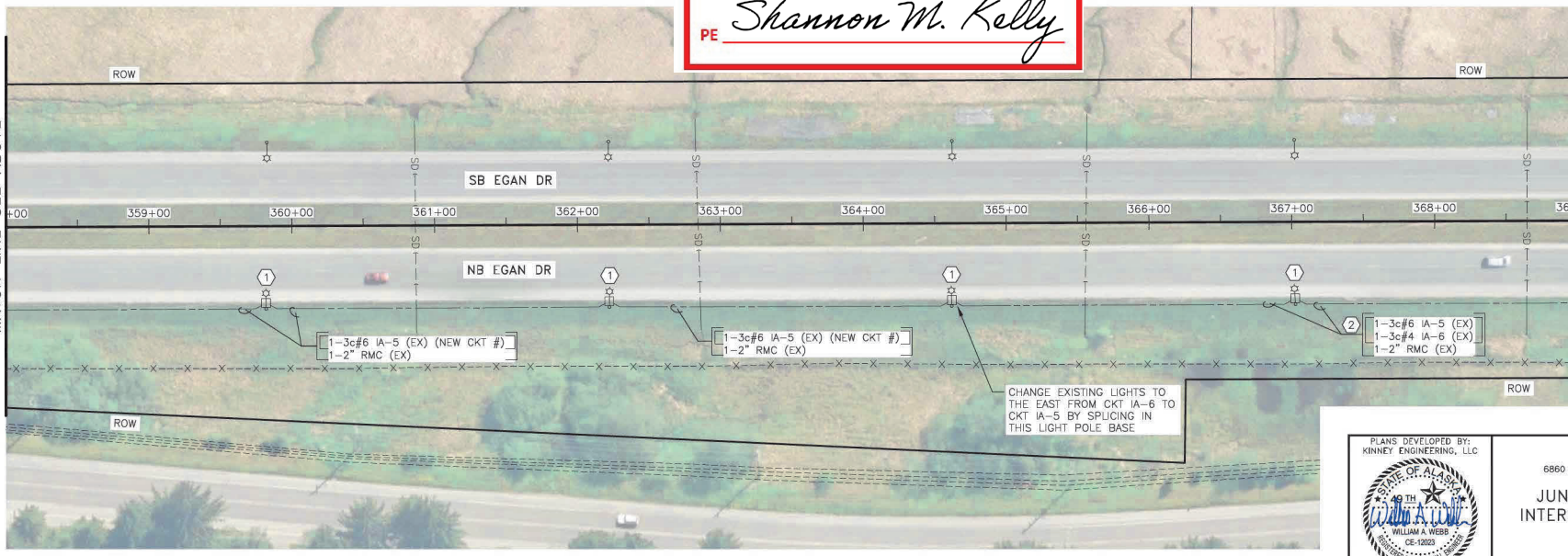

MATCH LINE SEE ABOVE

MATCH LINE SEE SHEET H6

- NOTES:**
- REPLACE EXISTING HPS LUMINAIRES FOR NB EGAN DRIVE WITH LED FIXTURES. COMBINE EXISTING LIGHTING CIRCUITS. USE ABANDONED CIRCUIT FOR RADAR SPEED SIGN.
 - CIRCUIT NUMBERS AND CONDUCTOR SIZES ARE BASED ON ASBUILT DATA. CONTRACTOR TO VERIFY AND NOTIFY ENGINEER OF DISCREPANCIES.

- SHEET NOTES:**
- REPLACE HPS LIGHT FIXTURE WITH LED FIXTURE. SEE H11.
 - REMOVE ABANDONED CONDUCTORS FOR CIRCUIT IA-6



STATE OF ALASKA DEPARTMENT OF TRANSPORTATION AND PUBLIC FACILITIES
 8860 GLACIER HIGHWAY JUNEAU, AK 99811
 (907) 465-1763

JUNEAU: EGAN-YANDUKIN INTERSECTION IMPROVEMENTS

ELECTRICAL PLAN

PLANS DEVELOPED BY: KINNEY ENGINEERING, LLC, 3009 Arctic Blvd., Suite 400 Anchorage, Alaska 99503 (907) 346-2373 CERT. OF AUTH. NO. 1102
 FILE: 00307-J5-HB ELECTRICAL PLANS.dwg DATE: 9/13/22 4:19 PM LAYOUT: H6 DESIGNED: JAM CHECKED: LW DRAFTED: AF

NO.	DATE	REVISION	STATE	PROJECT DESIGNATION	YEAR	SHEET NO.	TOTAL SHEETS
			ALASKA	0003261/SFHWHY00307	2022	H6	H11

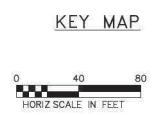
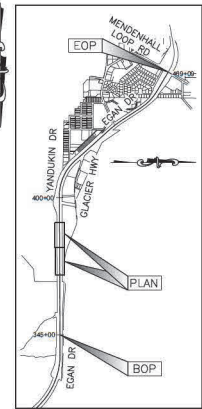
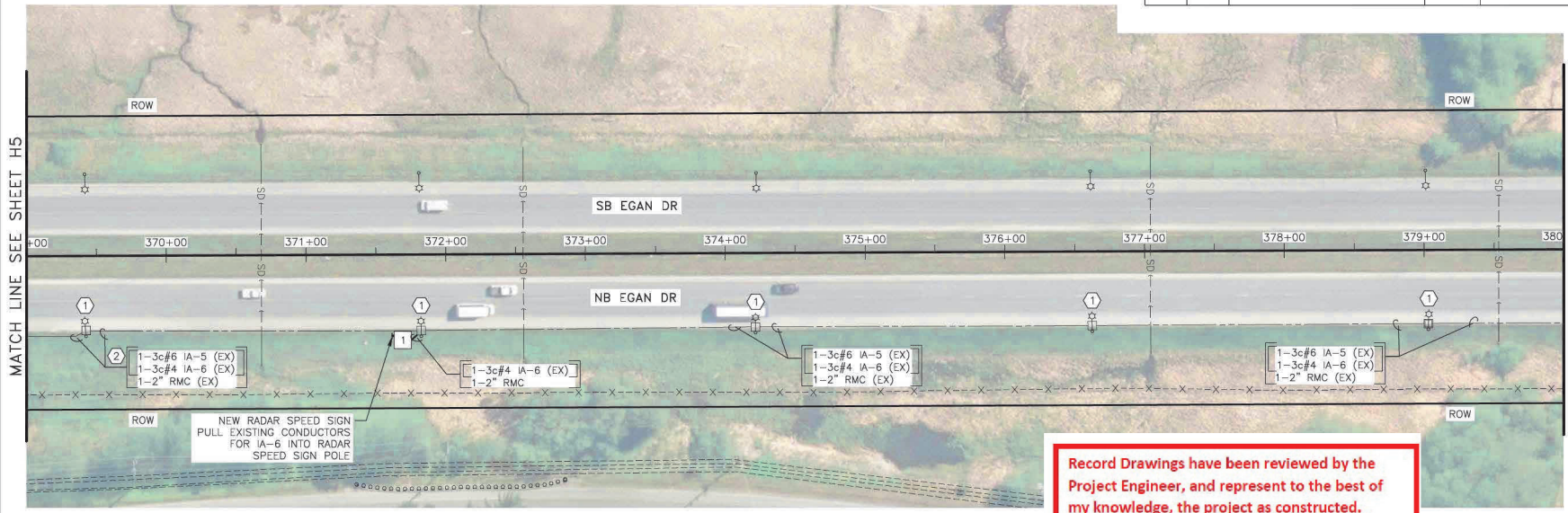

Record Drawings have been reviewed by the Project Engineer, and represent to the best of my knowledge, the project as constructed.
Shannon M. Kelly
 PE

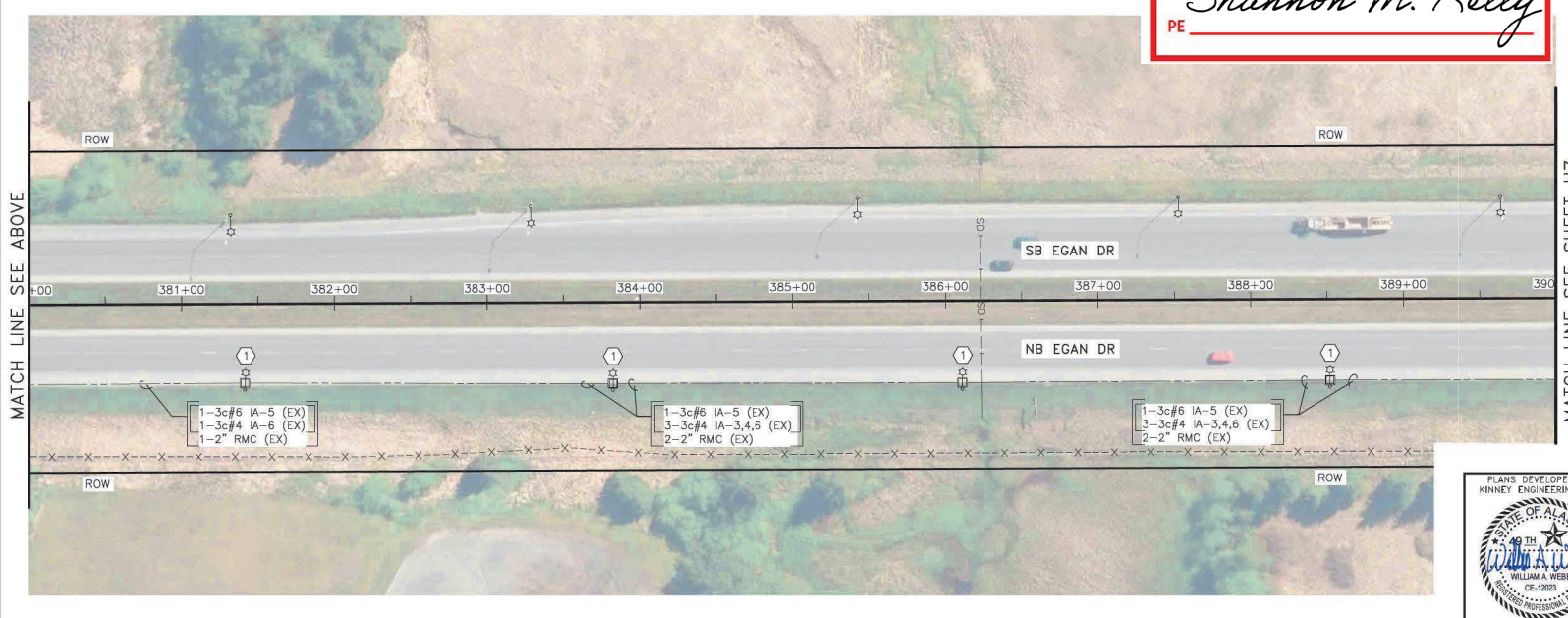

- SHEET NOTES:**
- ① REPLACE HPS LIGHT FIXTURE WITH LED FIXTURE. SEE H11.
 - ② REMOVE ABANDONED CONDUCTORS FOR CIRCUIT IA-6



STATE OF ALASKA DEPARTMENT OF TRANSPORTATION AND PUBLIC FACILITIES
 8860 GLACIER HIGHWAY JUNEAU, AK 99811
 (907) 465-1753
JUNEAU: EGAN-YANDUKIN INTERSECTION IMPROVEMENTS
 ELECTRICAL PLAN

PLANS DEVELOPED BY: KINNEY ENGINEERING, LLC, 3009 Arctic Blvd., Suite 400, Anchorage, Alaska 99503 (907) 346-2373 CERT. OF AUTH. NO. 1102
 FILE: 00007-15-HB ELECTRIC PLANS.DWG DATE: 9/13/22 4:19 PM

DRAFTED / AF
 CHECKED / JW
 DESIGNED / JAM

LAYOUT / H7

MATCH LINE SEE SHEET H6

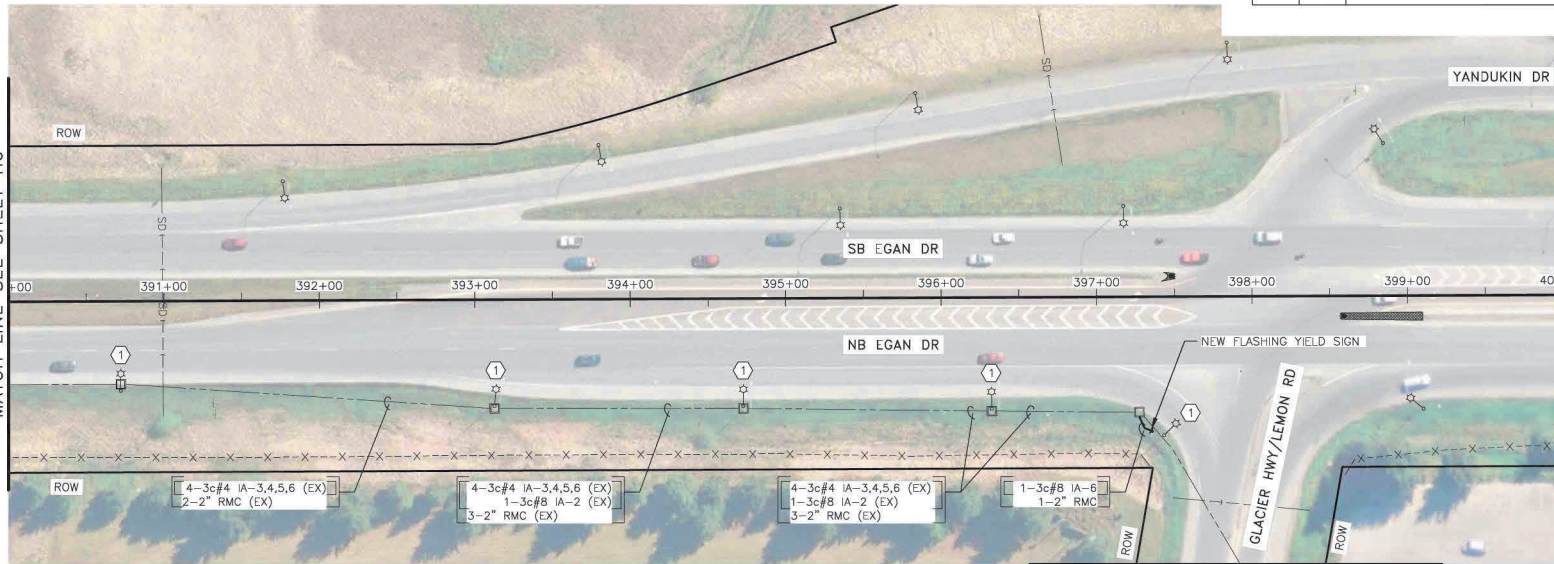

MATCH LINE SEE BELOW

NO.	DATE	REVISION	STATE	PROJECT DESIGNATION	YEAR	SHEET NO.	TOTAL SHEETS
			ALASKA	0003261/SFHWHY00307	2022	H7	H11

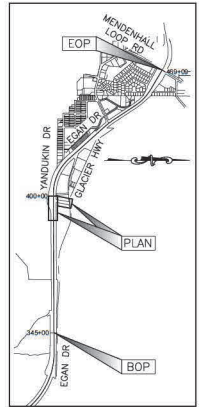

KEY MAP

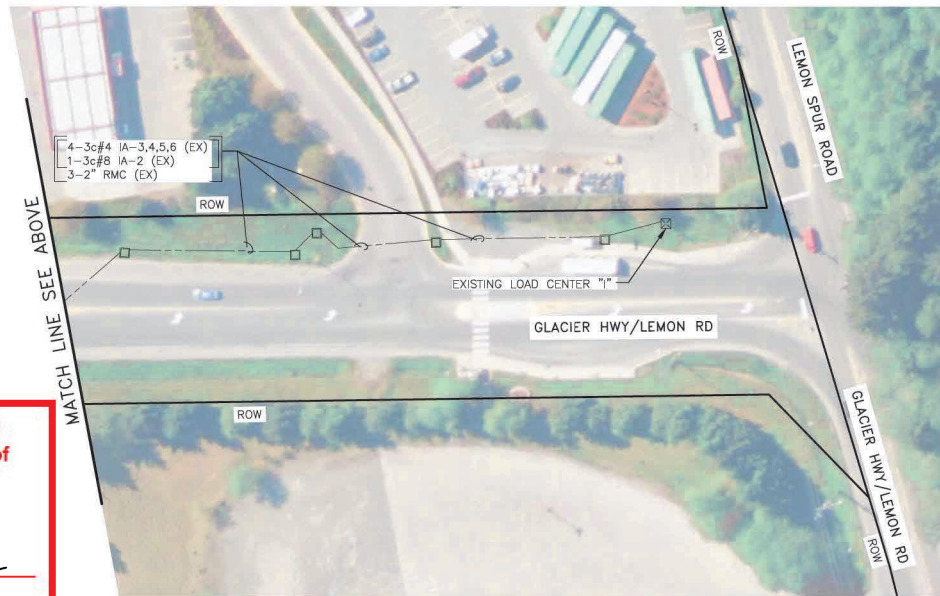
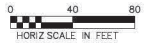

MATCH LINE SEE ABOVE

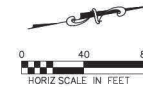

SHEET NOTES:

- ① REPLACE HPS LIGHT FIXTURE WITH LED FIXTURE. SEE H11.
- ② SPLICE 1-3c#8 INTO EXISTING CABLE FOR CKT IA-6 TO ENABLE CONNECTION TO NEW SIGN

Record Drawings have been reviewed by the Project Engineer, and represent to the best of my knowledge, the project as constructed.

PE Shannon M. Kelly



PLANS DEVELOPED BY:
 KINNEY ENGINEERING, LLC

STATE OF ALASKA DEPARTMENT OF
 TRANSPORTATION
 AND PUBLIC FACILITIES
 8860 GLACIER HIGHWAY JUNEAU, AK 99811
 (907) 468-1783

**JUNEAU: EGAN-YANDUKIN
 INTERSECTION IMPROVEMENTS**

ELECTRICAL PLAN

PLANS DEVELOPED BY: KINNEY ENGINEERING, LLC, 3009 Arctic Blvd., Suite 400 Anchorage, Alaska 99503 (907) 346-2373 CERT. OF AUTH. NO. 1102
 FILE: 00307-J5-H8 ELECTRICAL PLANS.dwg DATE: 9/13/22 4:20 PM LAYOUT: H8 DESIGNED: JAM CHECKED: WJW DRAFTED: AF

NO.	DATE	REVISION	STATE	PROJECT DESIGNATION	YEAR	SHEET NO.	TOTAL SHEETS
			ALASKA	0003261/SFHWY00307	2022	H8	H11

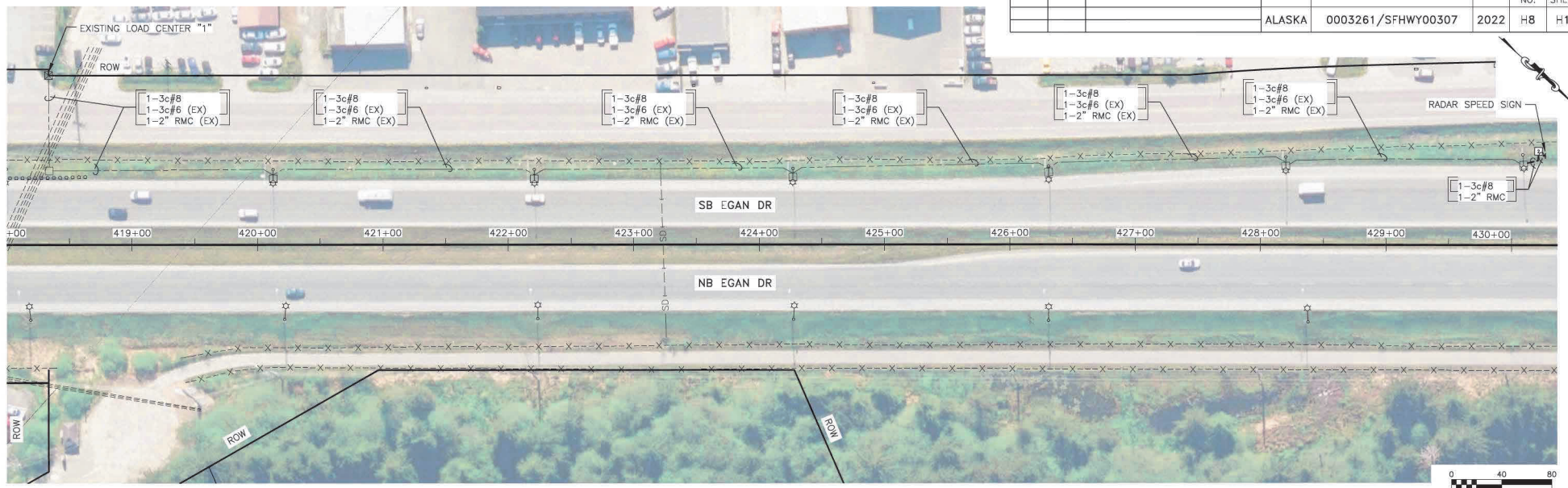

NOTES:

1. WHEN ADDING NEW CONDUCTORS TO CONDUIT WITH EXISTING CONDUCTORS, REMOVE EXISTING CONDUCTORS AND REFILL ALL CONDUCTORS TOGETHER AS REQUIRED BY THE SPECIFICATIONS.

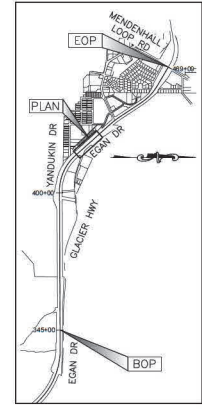

Record Drawings have been reviewed by the
 Project Engineer, and represent to the best of
 my knowledge, the project as constructed.
 PE *Shannon M. Kelly*



STATE OF ALASKA DEPARTMENT OF
 TRANSPORTATION
 AND PUBLIC FACILITIES
 6860 GLACIER HIGHWAY JUNEAU, AK 99811
 (907) 465-1753
**JUNEAU: EGAN-YANDUKIN
 INTERSECTION IMPROVEMENTS**
 ELECTRICAL PLAN

NO.	DATE	REVISION	STATE	PROJECT DESIGNATION	YEAR	SHEET NO.	TOTAL SHEETS
			ALASKA	0003261/SFHWY00307	2022	H9	H11

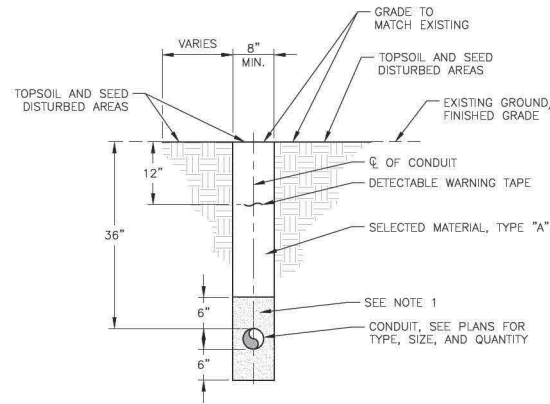

CONDUIT TRENCH DETAIL ADJACENT TO ROADWAYS AND PATHWAYS

NTS

NOTES:

1. PROVIDE CONDUIT BEDDING AND BACKFILL PER SPECIFICATIONS SECTION 660-3.01.3, EXCAVATING AND BACKFILLING. BACKFILL MATERIAL WITHIN 8" OF CONDUIT SHALL BE EASILY COMPACTABLE, FREE OF ROCKS EXCEEDING 1" MAXIMUM DIMENSION AND HAVE A PLASTICITY INDEX NOT GREATER THAN 6.
2. APPLY 4" TOPSOIL AND SEED OR SOD TO ALL DISTURBED AREAS UNLESS OTHERWISE NOTED.

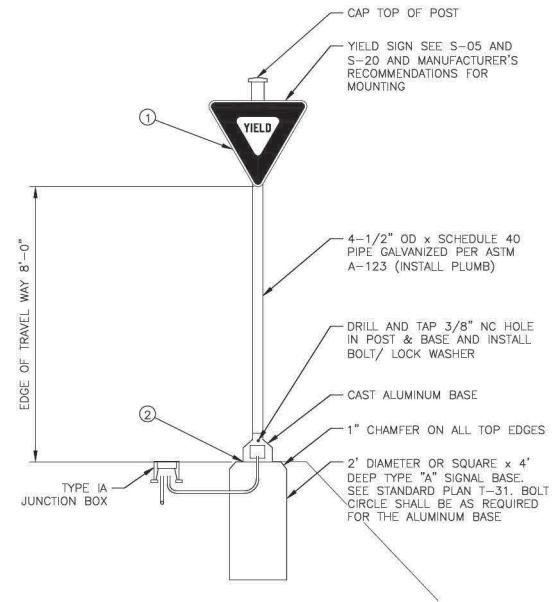

MATERIALS LIST*

1 TWO FOOT DIAMETER OR SQUARE x 4' BASE & ANCHOR BOLTS; VE-PED CATALOG #1-SE5031 OR APPROVED EQUAL.
1-POST & BREAKAWAY CAST ALUMINUM BASE; VE PED CATALOG #0-SE-5030 OR APPROVED EQUAL.
1-LED EMBEDDED YIELD SIGN (48"x48")

* MATERIALS LISTED ARE FOR ONE FLASHER INSTALLATION AND DOES NOT INCLUDE CONDUIT - J-BOXES - CABLES OR OTHER MISCELLANEOUS HARDWARE.

FLASHING SIGN INSTALLATION

NTS

NOTES:

- ① CONNECT LED SIGN ELECTRICAL ENCLOSURE TO SIGN POST WITH LIQUID-TIGHT FLEXIBLE METAL CONDUIT ON BACK OF SIGN.
- ② INSTALL SIGN BASE FLUSH WITH FINISHED GRADE. IN SLOPED AREAS, INSTALL CENTER OF FOUNDATION AT FINISHED GRADE AND WARP SLOPE TO MATCH.

Record Drawings have been reviewed by the Project Engineer, and represent to the best of my knowledge, the project as constructed.

 PE Shannon M. Kelly



STATE OF ALASKA DEPARTMENT OF TRANSPORTATION AND PUBLIC FACILITIES
 6860 GLACIER HIGHWAY, JUNEAU, AK 99811
 (907) 465-1753
JUNEAU: EGAN-YANDUKIN INTERSECTION IMPROVEMENTS
TRENCHING, FLASHING SIGN AND RADAR SPEED SIGN DETAILS

Record Drawings have been reviewed by the Project Engineer, and represent to the best of my knowledge, the project as constructed.

PE Shannon M. Kelly

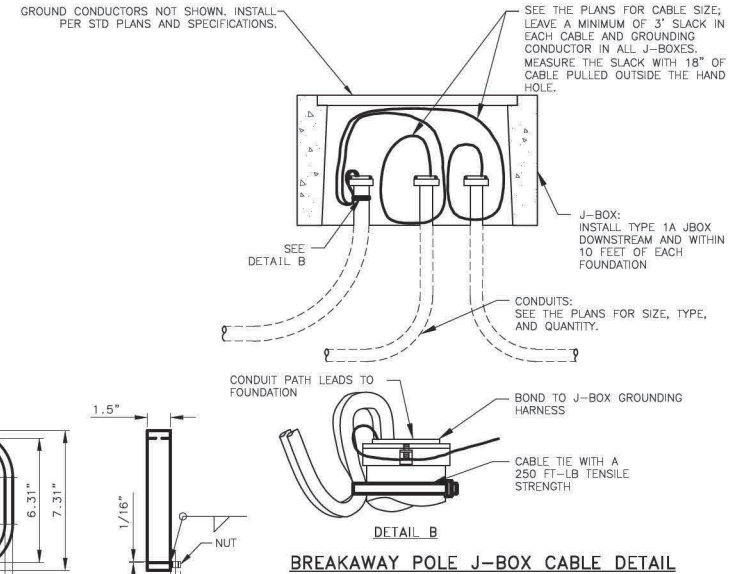
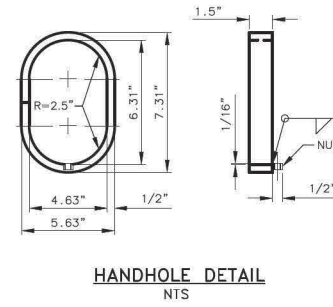
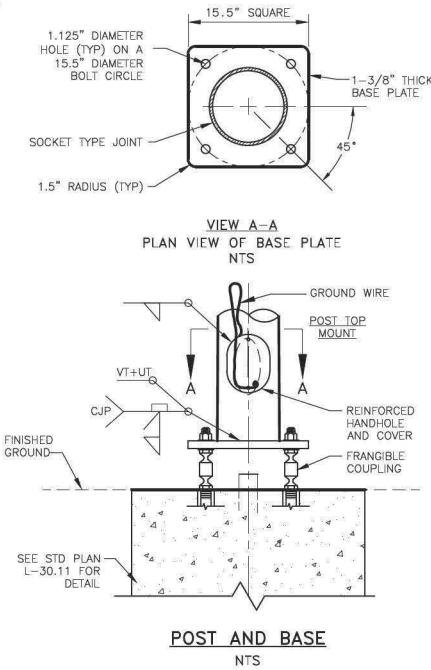
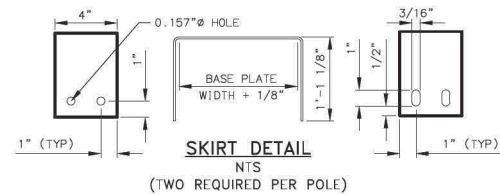
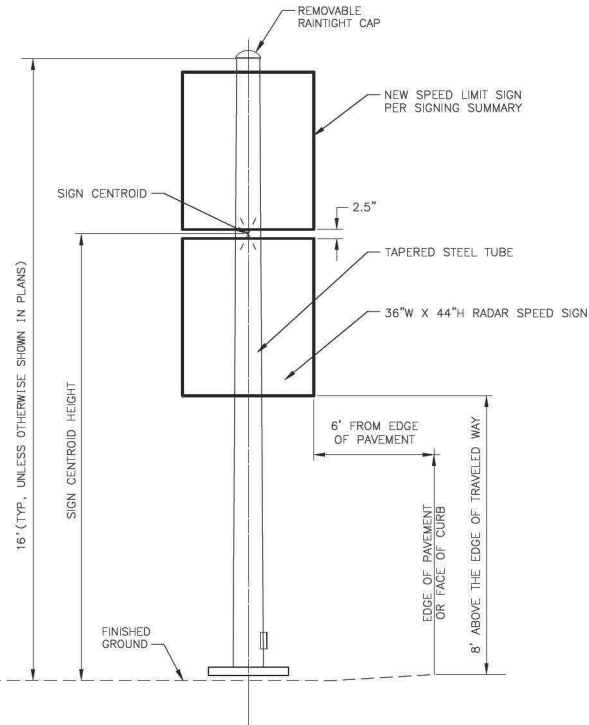

FIXED DESIGN ELEMENTS	
ALL ASSEMBLIES	
LENGTH	16'(TYP, MAY VARY IN PLANS)
FIXED END DIAMETER O.D.	10.0"
TAPER	0.14" /FT
TUBE THICKNESS	7 GA.
HAND-HOLE O.D.	5.63" X 7.31"
BASE PLATE	15.5" X 15.5" X 1.375"
BOLT CIRCLE	15.5"
FRANGIBLE COUPLING	MODEL 5100 POLE SAFE OR APPROVED EQUAL
MATERIAL PROPERTIES	
TUBE	ASTM A572 GR. 55
BASEPLATE	AASHTO M270 F3, GR 50
TOP PLATE	ASTM A36
HANDHOLE REINFORCEMENT	ASTM A53, GR. B
FINISH	AASHTO M111 & M232

NOTES:

- DESIGN POLE ASSEMBLIES TO THE 2013 AASHTO STANDARD SPECIFICATIONS FOR STRUCTURAL SUPPORTS FOR HIGHWAY SIGNS WITH 2015 INTERIM REVISIONS, LUMINAIRE AND TRAFFIC SIGNALS, THE ALASKA STANDARD SPECIFICATIONS, STANDARD MODIFICATIONS, SPECIAL PROVISIONS AND THESE PLANS. DESIGN FOR A BASIC WIND SPEED OF 100 MPH, FATIGUE CATEGORY II.
- POLES SHALL BE DESIGNED AND FABRICATED TO INCORPORATE ALL FIXED DESIGN ELEMENTS.
- DESIGN AND FABRICATE TUBES FROM ONE PIECE OF TAPERED STEEL.
- STEEL GREATER THAN 1/2" THICK SHALL CONFORM TO AASHTO M270 AND SHALL MEET THE FRACTURE CRITICAL CHARPY V-NOTCH IMPACT TEST REQUIREMENTS FOR ZONE 3.
- INSTALL A 0.625" THICK 3003-H14 ALUMINUM SHEET SKIRT AROUND THE FRANGIBLE COUPLINGS FASTENED WITH STAINLESS SHEET METAL SCREWS.
- THE DEPARTMENT WILL REJECT DAMAGED OR DEFECTIVE POLES FOR ANY OF THE FOLLOWING, INCLUDING BUT NOT LIMITED TO:
 A. VARIANCES FROM APPROVED SHOP DRAWINGS.
 B. VARIANCES FROM FIXED DESIGN ELEMENTS.
 C. OUT OF ROUND SECTIONS ARE OUT OF ROUND WHEN THE DIAMETERS OF ROUND MEMBERS EXCEED 2 PERCENT OF THE DIMENSION SPECIFIED ON THE SHOP DRAWINGS.
 D. BOWED WITH SWEEPS EXCEEDING 0.75" INCH THROUGHOUT THE LENGTH OF THE POLE, MASTARM, OR SEGMENT.
 E. DAMAGED OR DENTED FINISHES.
- WELD SIZE TO BE DETERMINED BY MANUFACTURER.
- PROVIDE PERMANENT TAGS PER SECTION 740 TABLE 740-1 OF THE SPECIFICATIONS.
- THIS DRAWING IS INTENDED FOR POLE DESIGN PURPOSES ONLY. ASSEMBLY CONFIGURATIONS ARE FOR LOADING PURPOSES AND MAY DIFFER FROM THOSE SHOWN IN PLANS. POLES HAVE NOT BEEN EVALUATED FOR LOADING CONDITIONS MORE SEVERE THAN THOSE SHOWN AND WILL REQUIRE INDIVIDUAL ANALYSIS WHEN ENCOUNTERED.

PLANS DEVELOPED BY:
KINNEY ENGINEERING, LLC

STATE OF ALASKA DEPARTMENT OF TRANSPORTATION AND PUBLIC FACILITIES
6860 GLACIER HIGHWAY JUNEAU, AK 99811
(907) 468-1783

JUNEAU: EGAN-YANDUKIN INTERSECTION IMPROVEMENTS

BREAKAWAY RADAR SPEED SIGN POLE DETAIL

WILLIAM A. WEBB
CE-12023

NO.	DATE	REVISION	STATE	PROJECT DESIGNATION	YEAR	SHEET NO.	TOTAL SHEETS
			ALASKA	0003261/SFHWHY00307	2022	H11	H11

STREET LIGHTING CRITERIA	
ROADWAY CHARACTERISTICS	
ROADWAY LIGHTING STANDARD:	IESNA RP-8-2014
CALCULATION ZONE:	ENTIRE ROADWAY
STREET CLASSIFICATION:	MAJOR
PEDESTRIAN CLASSIFICATION:	LOW
PAVEMENT CLASSIFICATION:	R3
TRAFFIC FLOW:	ONE-WAY
LANE WIDTH:	12 FT.
NO. OF LANES, LEFT / RIGHT:	2
MEDIAN:	NONE
FIXTURE SETBACK FROM FOGLINE:	0 FT
MOUNTING HEIGHT:	40 FT
LUMINAIRE DEPRECIATION	
LED - TOTAL LIGHT LOSS FACTOR (LFF):	0.85
ROADWAY LUMINANCE CRITERIA	
AVERAGE MAINTAINED (Lavg):	0.6 CD/SQ M
MINIMUM MAINTAINED (Lmin):	0.3 CD/SQ M
Lavg/Lmin RATIO (MAXIMUM):	<= 3.5:1
Lmax/Lmin RATIO (MAXIMUM):	<= 6.0:1
Lvmax/Lavg VEILING LUMINANCE RATIO (MAXIMUM):	<= 0.3:1

LUMINAIRE SCHEDULE										
TYPE	MANUFACTURER & MODEL NO.	LIGHT SOURCE	IES TYPE OPTICS	INITIAL LUMENS	COLOR TEMP (CCT)	DRIVER CURRENT	VOLTAGE & WATTS	POWER FACTOR	MOUNTING	REMARKS
1	GE EVOLVE ERL2-5-21-C5-40-D-GRAY	LED	TYPE III	21,000	4000K	---	480V 160W	>0.9	HORIZ. TENON	NOTES 1, 2

LUMINAIRE NOTES:

- MODEL AND MANUFACTURER LISTED ARE BASIS OF DESIGN. PROVIDE SCHEDULED LUMINAIRES OR APPROVED EQUAL. REFER TO SECTION 740 SPECIFICATIONS.
- LUMINAIRE SHALL BE FURNISHED WITH 7-PIN NEMA PHOTOCCELL RECEPTACLE AND SHORTING CAP.

Record Drawings have been reviewed by the Project Engineer, and represent to the best of my knowledge, the project as constructed.

 PE *Shannon M. Kelly*

EXISTING/REWORK AS NOTED		LOAD CENTER SUMMARY	
LOAD CENTER:	TYPE: 1	UTILITY SOURCE:	NEARBY POWER POLE
LOCATION:	GLACIER HWY AND OLD DAIRY RD, NEAR SE QUAD	SERVICE:	100 AMP, 480/277 VOLT, 1-PHASE, 3-WIRE
REMARKS:	INSTALLED 2015, OWNED BY DOT&P	MAX. AVAILABLE FAULT CURRENT:	
MAIN BREAKER:		100 AMP, 2-POLE, 480 VOLT	INTERRUPTING RATING: 14,000 AMP
DESCRIPTION		AUXILIARY EQUIPMENT SUMMARY	
SURGE ARRESTOR (NEW)	480	VOLT	POLES
PHOTOELECTRIC CONTROL	480	2	AMP
LIGHTING CONTACTOR, TYP. 2	600	12	30
		REMARKS: INSTALL NEW SURGE ARRESTOR	
		EXISTING	
		CONTACTOR (EXISTING)	
PANEL 'A' SCHEDULE		480/277 VOLT, 1-PHASE, 3-WIRE, 100A BUS	
CKT. NO.	DESCRIPTION	CKT. BKR.	KVA / LNE
1*	LIGHTING CIRCUIT LTG 1 (EXISTING)	20A/2P	2.0 4.0
2*			4.0 4*
5*	LIGHTING CIRCUIT: F. MEYER, SOUTH LT (EXISTING) LTG 3	20A/2P	2.0 3.0
7*			3.0 8*
9*	LIGHTING CIRCUIT: F. MEYER, SOUTH RT (EXISTING) LTG 5	20A/2P	1.6 1.7
11*			1.6 1.7
13	PHOTOELECTRIC CONTROL (EXISTING)	15A/1P	0.1 0.3
15			1.8
17			20
19			22
21			24
23			26
25			28
27			30
		10 FLASHING SIGN AND RADAR SPEED SIGN (NEW)	
		12 (PREVIOUSLY LTG 6)	
		14 HEATER (EXISTING)	
		15A/1P 0.2	
		16 SPARE	
		18	
		20	
		22	
		24	
		26	
		28	
		30	
NOTES: LUM = LUMINAIRE		SERVICE LOAD: CONNECTED: 9.0 8.7 KVA 37 AMP	
* CIRCUIT ROUTED THROUGH CONTACTOR		DEMAND: 22.1 KVA 46 AMP	

LOAD CENTER 1 NOTES:

- COMBINE EXISTING LIGHTING CIRCUITS 5 AND 6 (SEE PLAN SHEETS).
- REMOVE CIRCUIT 6 FROM CONTACTOR. FURNISH AND INSTALL NEW 250vdc 480 VOLT TO 240 VOLT TRANSFORMER WITH SECONDARY FUSE BLOCK IN LOAD CENTER, POWERED FROM CIRCUIT 6. CONNECT EXISTING CIRCUIT 6 CONDUCTORS TO OUTPUT SIDE OF TRANSFORMER FOR CONNECTION TO ELECTRICAL SIGNS (SEE PLAN SHEETS)

EXISTING/REWORK AS NOTED		LOAD CENTER SUMMARY	
LOAD CENTER:	TYPE: 2	UTILITY SOURCE:	UG SERVICE FROM NEARBY POWER POLE
LOCATION:	OLD DAIRY ROAD, NEAR AIRPORT BLVD	SERVICE:	100 AMP, 480/240 VOLT, 1-PHASE, 3-WIRE
REMARKS:	INSTALLED 1992, OWNED BY DOT&P	MAX. AVAILABLE FAULT CURRENT:	
MAIN BREAKER:		100 AMP, 2-POLE, 480 VOLT	INTERRUPTING RATING: 14,000 AMP
DESCRIPTION		AUXILIARY EQUIPMENT SUMMARY	
PHOTOELECTRIC CONTROL	240	VOLT	POLES
	240	1	15
		REMARKS: EXISTING	
PANEL 'A' SCHEDULE		480/240 VOLT, 1-PHASE, 3-WIRE, 100A BUS	
CKT. NO.	DESCRIPTION	CKT. BKR.	KVA / LNE
1	LIGHTING CIRCUIT C (EXISTING)*	15A/2P	1.2 2.4
3			2.4 4
5	SOUTHBOUND RADAR SPEED SIGN (NEW)	20A/1P	0.1 0.3
7			0.2 8
9			10
11			12
13			14
15			16
17			18
19			20
21			22
23			24
25			26
27			28
		2 LIGHTING CIRCUIT D (EXISTING)*	
		6 RADIO ANTENNA (EXISTING)	
		15A/2P 1.2	
		15A/2P 0.2	
		0.2	
NOTES: LUM = LUMINAIRE		SERVICE LOAD: CONNECTED: 2.7 2.6 KVA 11 AMP	
* CIRCUIT ROUTED THROUGH CONTACTOR		DEMAND: 6.6 KVA 14 AMP	

LOAD CENTER 1 NOTES:

- INSTALL NEW 20A/1P BREAKER (NOT THROUGH CONTACTOR) FOR RADAR SPEED SIGN.



STATE OF ALASKA DEPARTMENT OF TRANSPORTATION AND PUBLIC FACILITIES
 6860 GLACIER HIGHWAY, JUNEAU, AK 99811
 (907) 468-1763
JUNEAU: EGAN-YANDUKIN INTERSECTION IMPROVEMENTS
 LOAD CENTER SUMMARIES

PLANS DEVELOPED BY: KINNEY ENGINEERING, LLC 3609 Arctic Blvd., Suite 400 Anchorage, Alaska 99503 (907) 346-2373 CERT. OF AUTH. NO. 1102
 FILE: 00307_T1-T2_TCP.dwg DATE: 19/13/22 4:21 PM LAYOUT: T1 DESIGNED: JAM CHECKED: WJ DRAFTED: AF

NO.	DATE	REVISION	STATE	PROJECT DESIGNATION	YEAR	SHEET NO.	TOTAL SHEETS
			ALASKA	0003261/SFHWY00307	2022	T1	T1

Record Drawings have been reviewed by the Project Engineer, and represent to the best of my knowledge, the project as constructed.

PE *Shannon M. Kelly*

GENERAL TRAFFIC CONTROL PLAN NOTES

- THIS IS A GENERALIZED TRAFFIC CONTROL PLAN (TCP) TO SHOW PERMANENT CONSTRUCTION SIGNS, ALLOWABLE ROAD CLOSURES, AND DETOUR ROUTES. THE CONTRACTOR SHALL DEVELOP AN APPROVED TCP AND AN APPROVED CONSTRUCTION PHASING PLAN IN ACCORDANCE WITH THIS PLAN AND SECTION 643 OF THE PROJECT SPECIFICATIONS.
- DO NOT RESTRICT THE THROUGH LANES ON EGAN DRIVE UNLESS AUTHORIZED BY THE ENGINEER. SEE SPECIFICATIONS FOR LIMITATIONS ON LANE RESTRICTIONS.
- CONSTRUCTION SIGNING SHALL BE IN PLACE ONLY WHEN THE CONDITIONS EXIST FOR WHICH THE SIGNS ARE INTENDED. CONSTRUCTION SIGNS SHALL NOT OBSCURE EXISTING TRAFFIC SIGNS.
- PROVIDE ACCESS TO COMMERCIAL PROPERTIES DURING THEIR BUSINESS HOURS. CONTRACTOR SHALL CONTACT ALL BUSINESSES IN THE PROJECT AREA TO COORDINATE AND ENSURE ACCESS.
- PROVIDE ACCESS THROUGH THE PROJECT FOR EMERGENCY VEHICLES.
- PROVIDE ACCESS FOR TRANSIT BUSES AND ITS USERS.
- PROVIDE PUBLIC NOTICE OF DETOURS AND CLOSURES IN ACCORDANCE WITH SECTION 643.
- BEFORE BEGINNING WORK WITHIN THE PROJECT LIMITS, ERECT TRAFFIC CONTROL DEVICES REQUIRED BY THE APPROVED TCP.
- PROVIDE TRAFFIC CONTROL DEVICES MEETING THE REQUIREMENTS OF SECTION 643.
- EXISTING SIGNS WHICH CONFLICT WITH CONSTRUCTION SIGNS SHALL BE COVERED.
- CONSTRUCTION SIGNS MAY NOT BE PLACED ON PORTABLE SIGN SUPPORTS FOR MORE THAN THREE CONSECUTIVE CALENDAR DAYS. SIGNS REQUIRED LONGER THAN THIS PERIOD SHALL BE MOUNTED ON A PERMANENT SIGN POST WITH THE EXCEPTION OF PEDESTRIAN TRAFFIC CONTROL SIGNS AND SIGNS MOUNTED ON A TYPE III BARRICADE WHICH MAY BE INSTALLED ON PORTABLE SIGN SUPPORTS FOR THE DURATION OF THEIR INSTALLATION.

- LOCATE EXISTING UNDERGROUND UTILITIES BEFORE INSTALLING PERMANENT CONSTRUCTION SIGN FOUNDATIONS.
- RESTORE EXISTING ROADSIDE SIGNS IMPACTED BY CONSTRUCTION SIGNAGE TO THEIR PRECONSTRUCTION CONDITIONS UNLESS OTHERWISE NOTED IN PLANS.
- SPECIAL CONSTRUCTION SIGNS SHALL BE FABRICATED OF MATERIALS CONFORMING TO SECTION 615 OF THE SPECIFICATIONS AND SHALL HAVE A BLACK LEGEND ON ORANGE BACKGROUND.
- CONSTRUCTION SIGNS ARE NOT PERMITTED TO BE INSTALLED ON UTILITY POLES.
- ALL SIGNS SHALL BE SUPPLEMENTED WITH HIGH LEVEL WARNING DEVICES.
- ALL BARRICADES SHALL HAVE ONE OPERABLE FLASHING LIGHT FOR EACH 10 FEET OF BARRICADE, WITH A MINIMUM OF TWO LIGHTS PER TYPE III BARRICADE EXCEPT IN A TAPER WHERE ONLY THE FIRST TWO LIGHTS SHALL FLASH (TYPE "A") AND THE REMAINDER SHALL BE STEADY BURN (TYPE "C").
- TYPE "A" FLASHING WARNING LIGHTS SHALL BE USED TO MARK THE TYPE III BARRICADES, ROAD CLOSURES, AND ADVANCE DETOUR SIGNING AT NIGHT.
- DEVICE SPACING ON TAPERS AND TANGENTS SHALL BE ONE (1) X THE POSTED SPEED LIMIT (IN FEET). SPEED LIMIT:
 EGAN DRIVE - 55 MPH
 YANDUKIN DRIVE - 40 MPH
 GLACIER HIGHWAY/LEMON ROAD - 45 MPH
- TRAFFIC CONTROL ZONES PROVIDING TWO-WAY TRAFFIC ON A ROAD REDUCED TO A SINGLE LANE REQUIRE A FLAGGER LOCATED AT EACH END.
- ALL TCP DEVICES AND SIGNS SHALL BE LOCATED PER THE ATM.

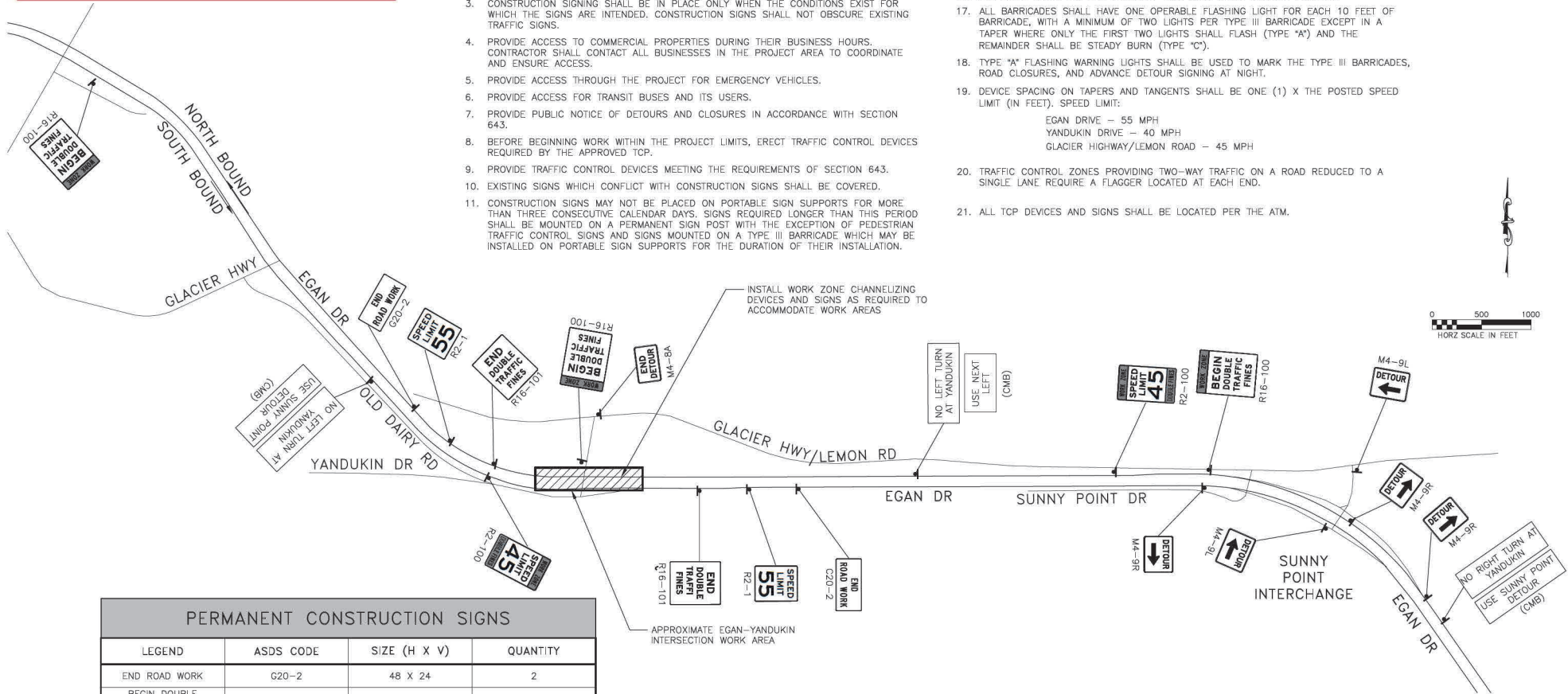

PERMANENT CONSTRUCTION SIGNS			
LEGEND	ASDS CODE	SIZE (H X V)	QUANTITY
END ROAD WORK	G20-2	48 X 24	2
BEGIN DOUBLE TRAFFIC FINES	R16-100	36 X 48	3
END DOUBLE TRAFFIC FINES	R16-101	36 X 42	3
WORK ZONE SPEED LIMIT 45	R2-100	30 X 48	4
SPEED LIMIT 55	R2-1	36 X 48	2
DOUBLE FINES	CW20-102	36 X 24	2

MOUNT CW20-102 PANELS ON EXISTING SPEED LIMIT SIGNS REMAINING IN SERVICE IN THE WORK ZONE.

PERMANENT CONSTRUCTION SIGN NOTES

- MOUNT CW20-102 PANELS ON EXISTING SPEED LIMIT SIGNS TO REMAIN IN SERVICE IN THE WORK ZONE. ALTERNATIVELY, COVER WITH WORK ZONE SPEED LIMIT SIGNS.
- SIGNS AND CMBs RELATED TO DETOUR ROUTING ARE NOT PERMANENT CONSTRUCTION SIGNS.

PLANS DEVELOPED BY: KINNEY ENGINEERING, LLC TOP NOT SEALED IN ACCORDANCE WITH ALASKA HIGHWAY PRECONSTRUCTION MANUAL SECTION 1400.3.5 DATED JANUARY 30, 2012.	STATE OF ALASKA DEPARTMENT OF TRANSPORTATION AND PUBLIC FACILITIES 6860 GLACIER HIGHWAY JUNEAU, AK 99811 (907) 468-1763 JUNEAU: EGAN-YANDUKIN INTERSECTION IMPROVEMENTS TRAFFIC CONTROL PLAN
--	--